

# PREVENT

# DETER

# SUPPORT



*Wellington Primary School*  
*Becoming an excellent institution that grows future-ready leaders*

# How do teachers manage my child's screen time?

- iPad allows teachers to rove around and not be desk-bound
- Classroom App
  - Update iPads regularly
  - iPadOS 14.4

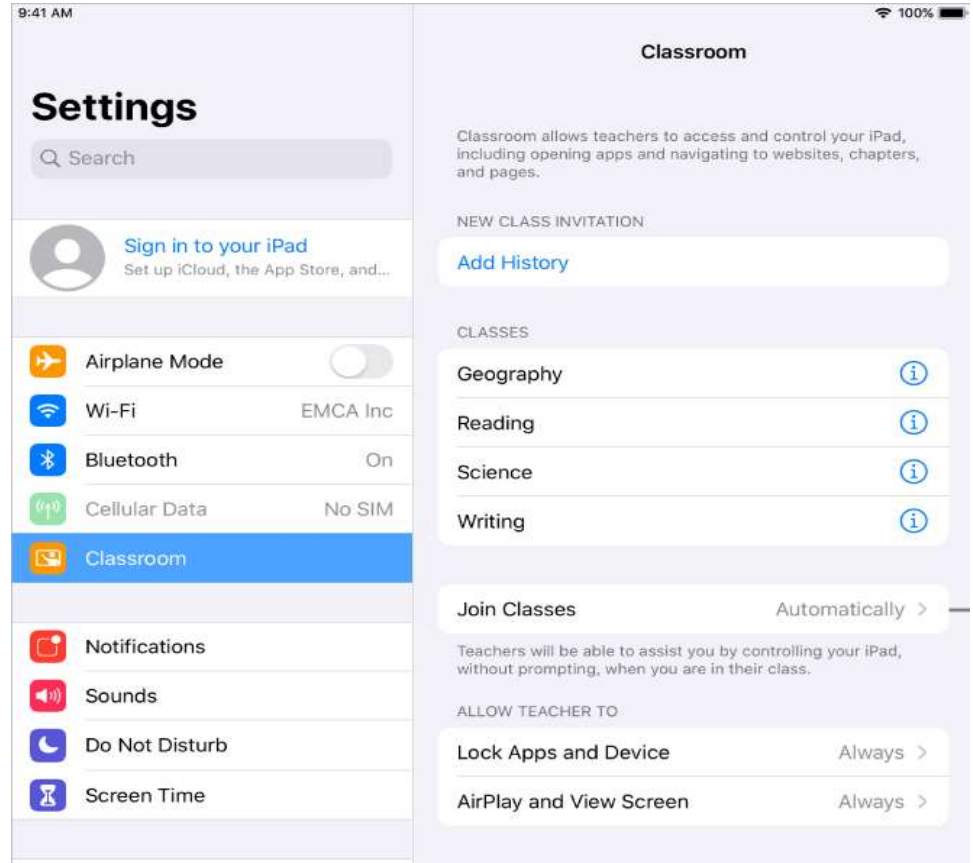

*Wellington Primary School*  
Becoming an excellent institution that grows future-ready leaders

# How do I manage my child's screen time?

## Establish rules, guidelines and habits

- Screen Time
  - This is My iPad
  - This is My Child's iPad
  - Family Sharing
- Downtime
- App limit
- Content & privacy restrictions
- Use third-party apps



*Wellington Primary School*  
Becoming an excellent institution that grows future-ready leaders

## Sample FAMILY MEDIA PLAN

- 1 Mobile Devices and TV not allowed in following areas in our house**  
Bedroom, Kitchen and dining area
- 2 We will not use mobile devices or other screen in the following times**  
While in Car, Family time, meal time and homework time
- 3 We will keep electronic devices switched off at night**  
We will keep these devices switched off, and charge outside bedroom ( In Living Room)
- 4 When we have recreational time, we will:**  
See media together and play video games together
  - We will watch educational shows and apps, use video calls to connect to others
  - We will NOT use media as a baby sitter and spend a lot of time in fast paced noisy videos.
- 5 We will balance online and offline time**  
We will spend time saved from 'online time' to read story books and play outside
- 6 We will follow these digital safety rules**  
NOT give personal information online  
NOT share private photos online

# Parents' role in supporting the use of technology

- Make your own family media use plan.
- It must be made to suit you, your family values and parenting style.
- Treat media as you would any other environment in your child's life.
- Know what platforms, software, and apps your children are using, what sites they are visiting on the web, and what they are doing online.



*Wellington Primary School*  
Becoming an excellent institution that grows future-ready leaders

## (Continuation) Parents' role in supporting the use of technology

- Screen time shouldn't always be alone time.
- Play a video game with your kids. It's a good way to demonstrate good sportsmanship and gaming etiquette.
- Watch a show with them; you will have the opportunity to introduce and share your own life experiences and perspectives—and guidance.



## (Continuation) Parents' role in supporting the use of technology

### Role Model

- Teach and model kindness and good manners online.
- Children are great mimics, plan and limit your own media use.
- Don't use technology as an emotional pacifier.



## (Continuation) Parents' role in supporting the use of technology

- Apps for kids
- More than 80,000 apps are labeled as educational, but little research has demonstrated their actual quality.
- Products pitched as "interactive" should require more than "pushing and swiping."
- Reviews about age-appropriate apps, games and programs to guide you in making the best choices for your children.
- Wise use will allow your child to go along way.





# Not all screen time is equal

- Schoolwork or homework done on screens  $\neq$  total daily allotment
- Quality of the screen time  $\neq$  parent assumes it is
  - Teenagers / adults - socializing is an important aspect of their lives, happens in video games, social media, etc.
  - Judge quality of child's screen time
    - Pay attention to how child responds after various media experiences
    - Ask how they feel about their most-used video games or apps
  - Not fixed, may change over time





# Create Apple ID

★ *If parent is not iOS user, start here*



*Wellington Primary School*  
*Becoming an excellent institution that grows future-ready leaders*

# Setting Screen Time



- ★ Create Apple ID (*if parent is not iOS user, start here*)
- ★ Family Sharing (*if parent is an iOS user, start here*)
- ★ This is my iPad
- ★ This is my child's iPad (*only to set screen time*)
- ★ Youtube
- ★ Google



# Create Apple ID (For child)

You can choose to create your Apple ID by:

1) Using yours/your child's device. Proceed to next slide for the steps to create Apple ID via own device.

OR

2) For parents who do not have your own Apple ID, you can create yours via your own/child's device, or go to <https://appleid.apple.com/> to create one. Follow through the steps.



*Wellington Primary School*  
*Becoming an excellent institution that grows future-ready leaders*

# Create Apple ID (For child)

1) Using yours/your child's device.  
Proceed to next slide for the steps to  
create Apple ID via own device.

\*You must have your own Apple ID if  
you want to sign your child in his/her  
own iPad. This will help when you want  
to activate Family Sharing - to control  
your child's Screen Time via your own  
device.

Step 1: Sign in to your iCloud.

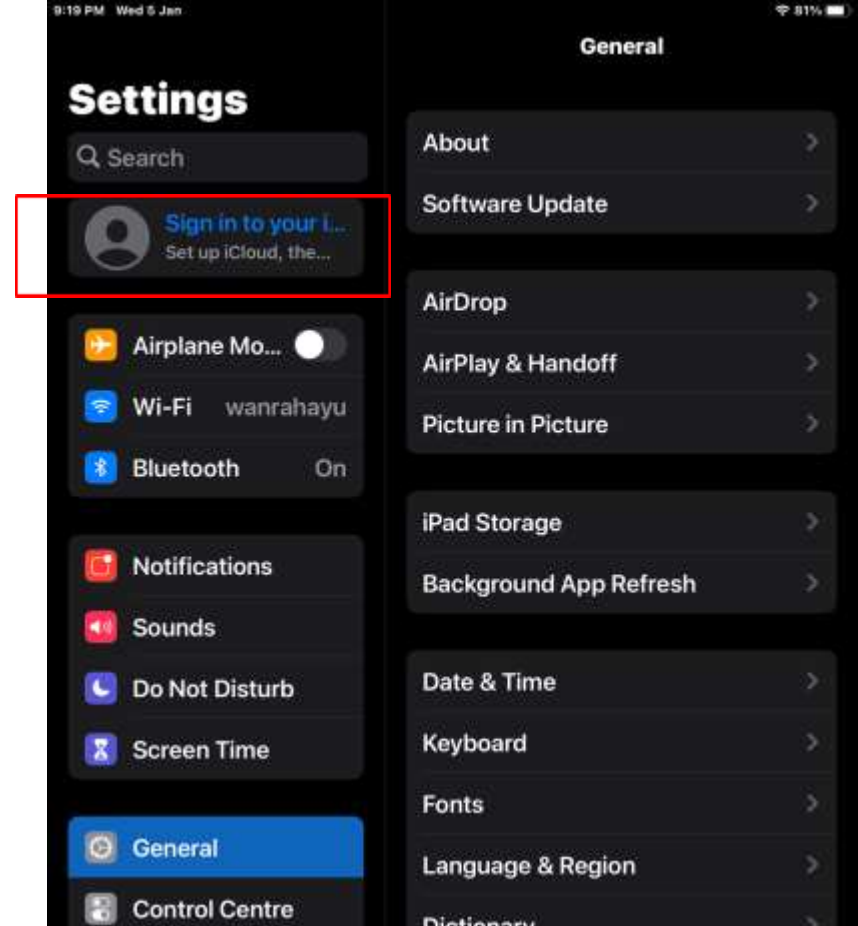

*Wellington Primary School*  
Becoming an excellent institution that grows future-ready leaders

# Create Apple ID

1) Using yours/your child's device. Proceed to next slide for the steps to create Apple ID via own device.

\*You must have your own Apple ID if you want to sign your child in his/her own iPad. This will help when you want to activate Family Sharing - to control your child's Screen Time via your own device.

Step 1: Sign in to your iCloud.

Step 2: Click on 'Don't have an Apple ID or forgot it?'



*Wellington Primary School*  
Becoming an excellent institution that grows future-ready leaders

# Create Apple ID

1) Using yours/your child's device. Proceed to next slide for the steps to create Apple ID via own device.

\*You must have your own Apple ID if you want to sign your child in his/her own iPad. This will help when you want to activate Family Sharing - to control your child's Screen Time via your own device.

Step 1: Sign in to your iCloud.

Step 2: Tap on 'Don't have an Apple ID or forgot it?'

Step 3: Tap on 'Create Apple ID'



# Create Apple ID

1) Using yours/your child's device. Proceed to next slide for the steps to create Apple ID via own device.

\*You must have your own Apple ID if you want to sign your child in his/her own iPad. This will help when you want to activate Family Sharing - to control your child's Screen Time via your own device.

Step 1: Sign in to your iCloud.

Step 2: Tap on 'Don't have an Apple ID or forgot it?'

Step 3: Tap on 'Create Apple ID'

Step 4: Enter the details required

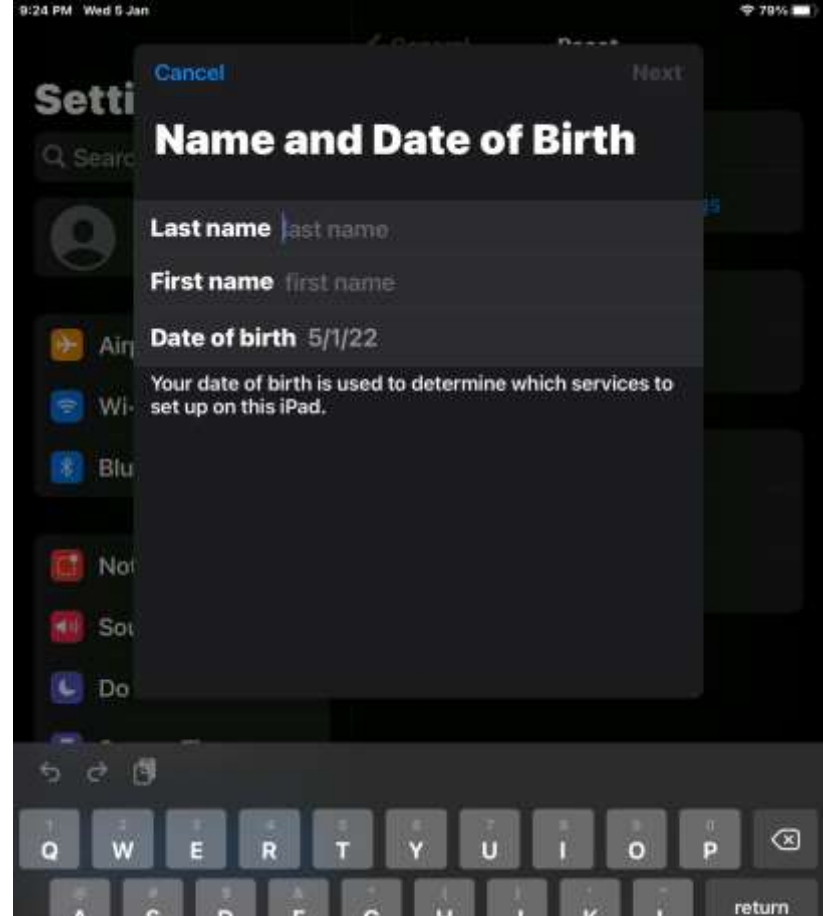

*Wellington Primary School*  
Becoming an excellent institution that grows future-ready leaders

# Create Apple ID

1) Using yours/your child's device. Proceed to next slide for the steps to create Apple ID via own device.

\*You must have your own Apple ID if you want to sign your child in his/her own iPad. This will help when you want to activate Family Sharing - to control your child's Screen Time via your own device.

Step 1: Sign in to your iCloud.

Step 2: Tap on 'Don't have an Apple ID or forgot it?'

Step 3: Tap on 'Create Apple ID'

Step 4: Enter the details required

Step 5: Parent required to enter parent's Apple ID

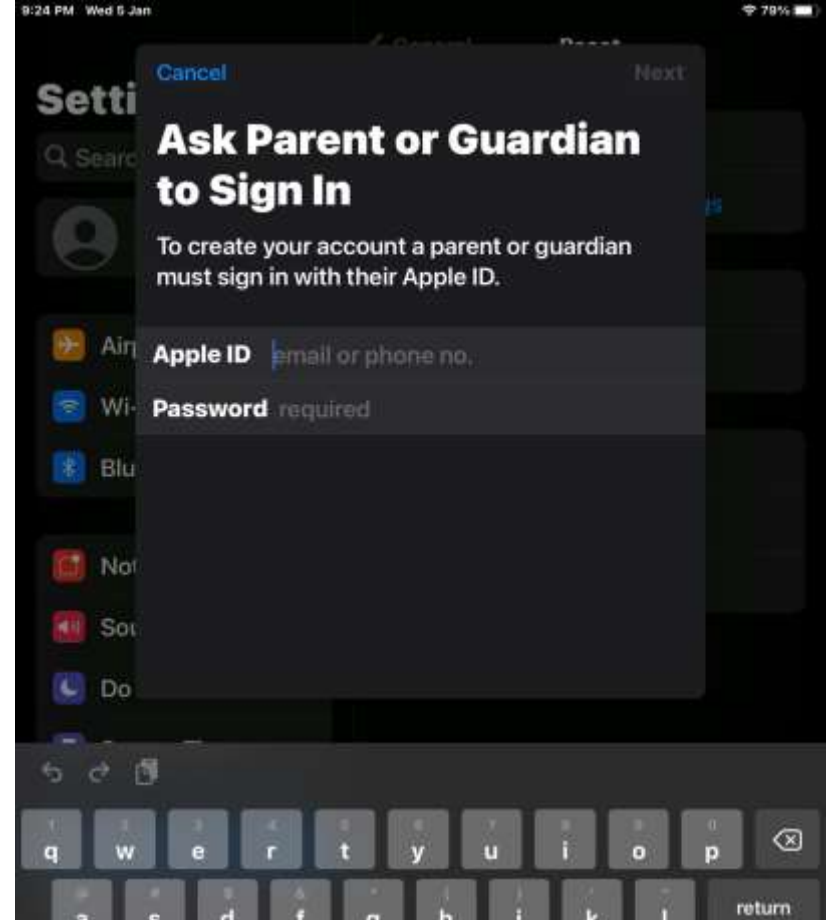

*Wellington Primary School*  
Becoming an excellent institution that grows future-ready leaders



# Create Apple ID

1) Using yours/your child's device. Proceed to next slide for the steps to create Apple ID via own device.

\*You must have your own Apple ID if you want to sign your child in his/her own iPad. This will help when you want to activate Family Sharing - to control your child's Screen Time via your own device.

Step 1: Sign in to your iCloud.

Step 2: Tap on 'Don't have an Apple ID or forgot it?'

Step 3: Tap on 'Create Apple ID'

Step 4: Enter the details required

Step 5: Parent required to enter parent's Apple ID

Step 6: If you have created an email address for your child, please key it here. If your child do not have an email address, tap on 'Do not have an email address?'

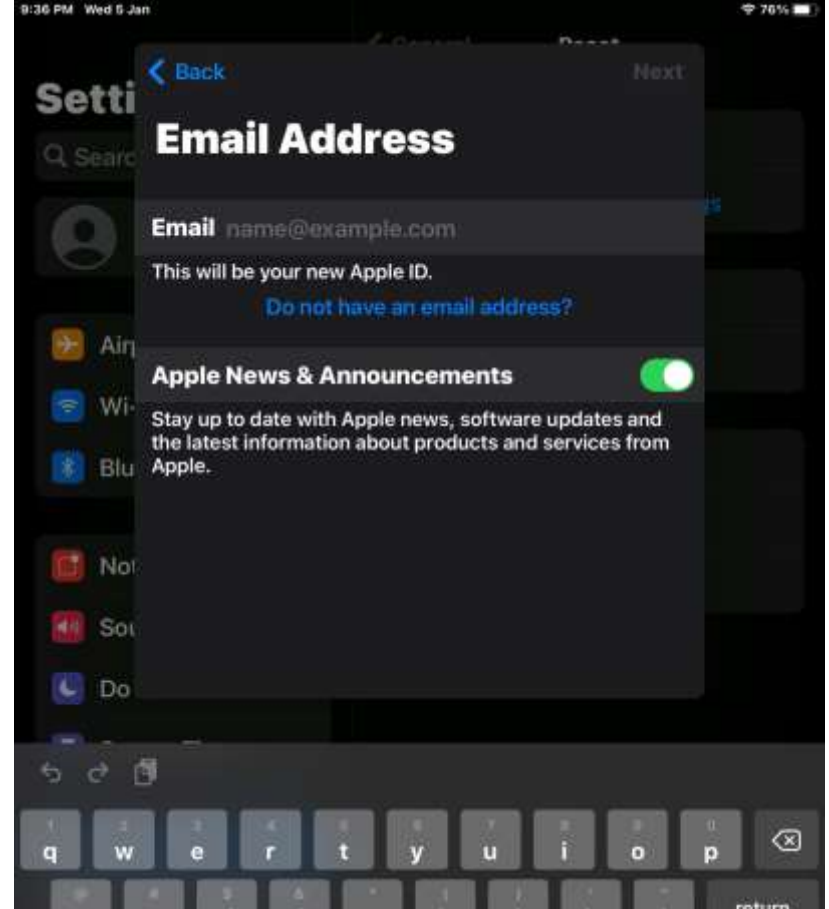

*Wellington Primary School*  
Becoming an excellent institution that grows future-ready leaders

# Create Apple ID

1) Using yours/your child's device. Proceed to next slide for the steps to create Apple ID via own device.

\*You must have your own Apple ID if you want to sign your child in his/her own iPad. This will help when you want to activate Family Sharing - to control your child's Screen Time via your own device.

Step 1: Sign in to your iCloud.

Step 2: Tap on 'Don't have an Apple ID or forgot it?'

Step 3: Tap on 'Create Apple ID'

Step 4: Enter the details required

Step 5: Parent required to enter parent's Apple ID

Step 6: If you have created an email address for your child, please key it here. If your child do not have an email address, tap on 'Do not have an email address?'

Step 7: Create a preferred name for your child's Apple ID

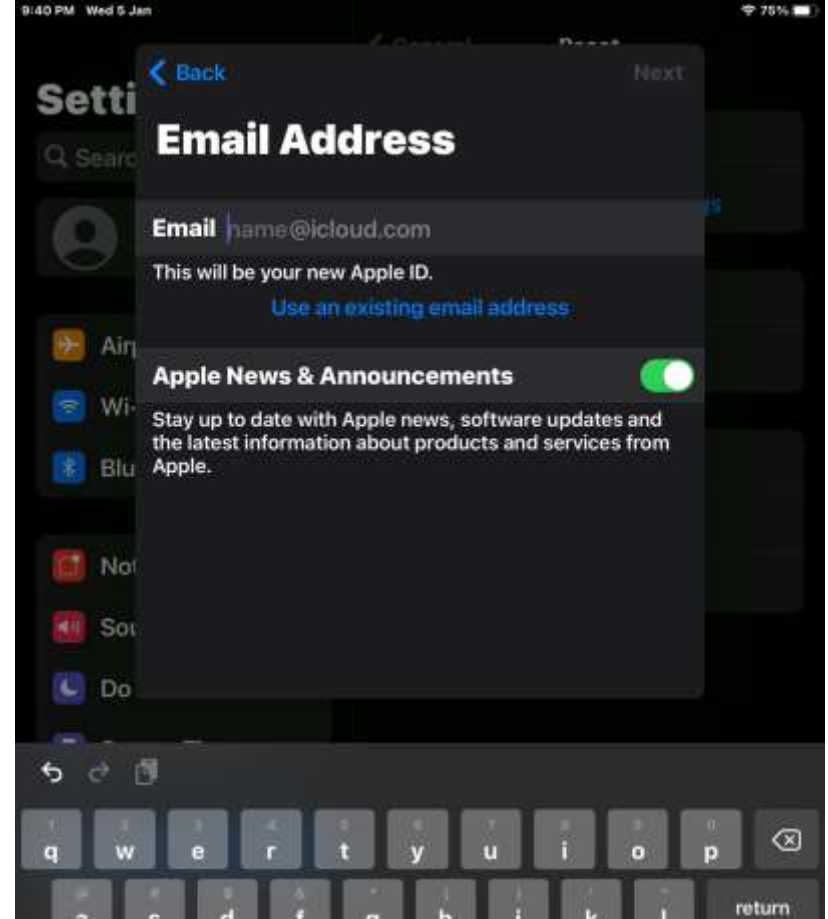

*Wellington Primary School*  
Becoming an excellent institution that grows future-ready leaders

# Create Apple ID

1) Using yours/your child's device. Proceed to next slide for the steps to create Apple ID via own device.

\*You must have your own Apple ID if you want to sign your child in his/her own iPad. This will help when you want to activate Family Sharing - to control your child's Screen Time via your own device.

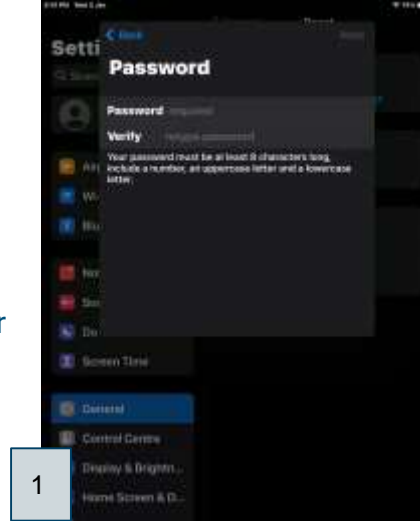

Step 8: Follow through the whole process

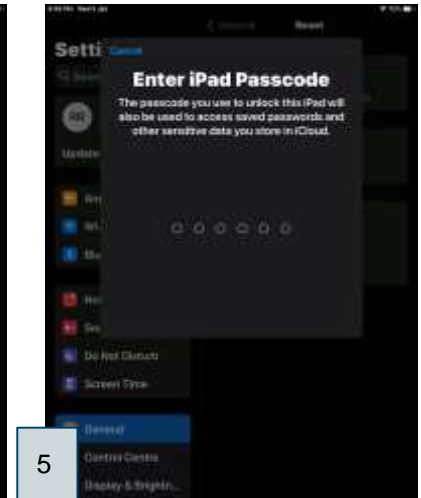
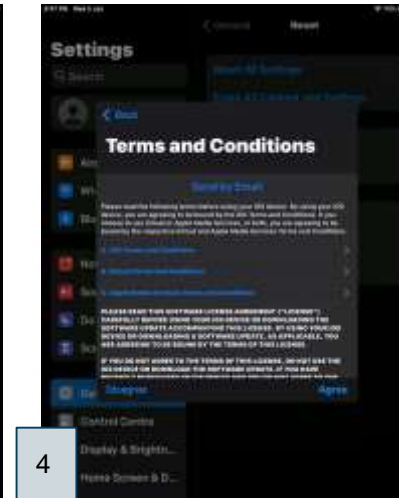
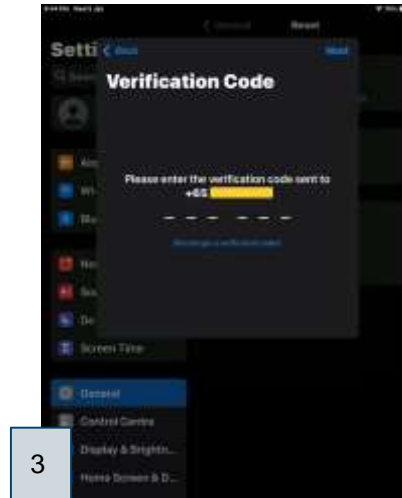

# Family Sharing

★ *If parent is an iOS user, start here*



*Wellington Primary School*  
*Becoming an excellent institution that grows future-ready leaders*

# Family Sharing

*If it's your child's device, you can set up **Screen Time** and create settings right on their device*

OR

- Use Family Sharing from your own device.
- Use Family Sharing to view reports and adjust settings right from your own device



*Wellington Primary School*  
*Becoming an excellent institution that grows future-ready leaders*

# Family Sharing

To **INVITE** family members to **Family Sharing** from your device

1. Go to Settings > [your name] > Family Sharing.

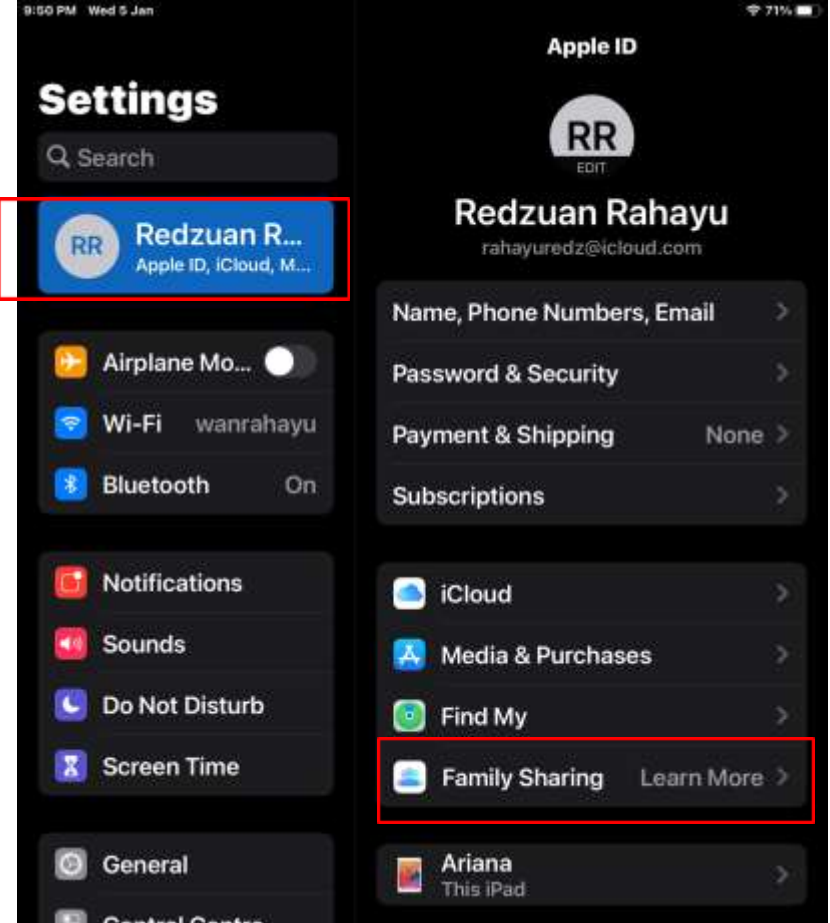

*Wellington Primary School*  
Becoming an excellent institution that grows future-ready leaders

# Family Sharing

To **INVITE** family members to **Family Sharing** from your device

1. Go to Settings > [your name] > Family Sharing
2. Tap 'Set Up Your Family'

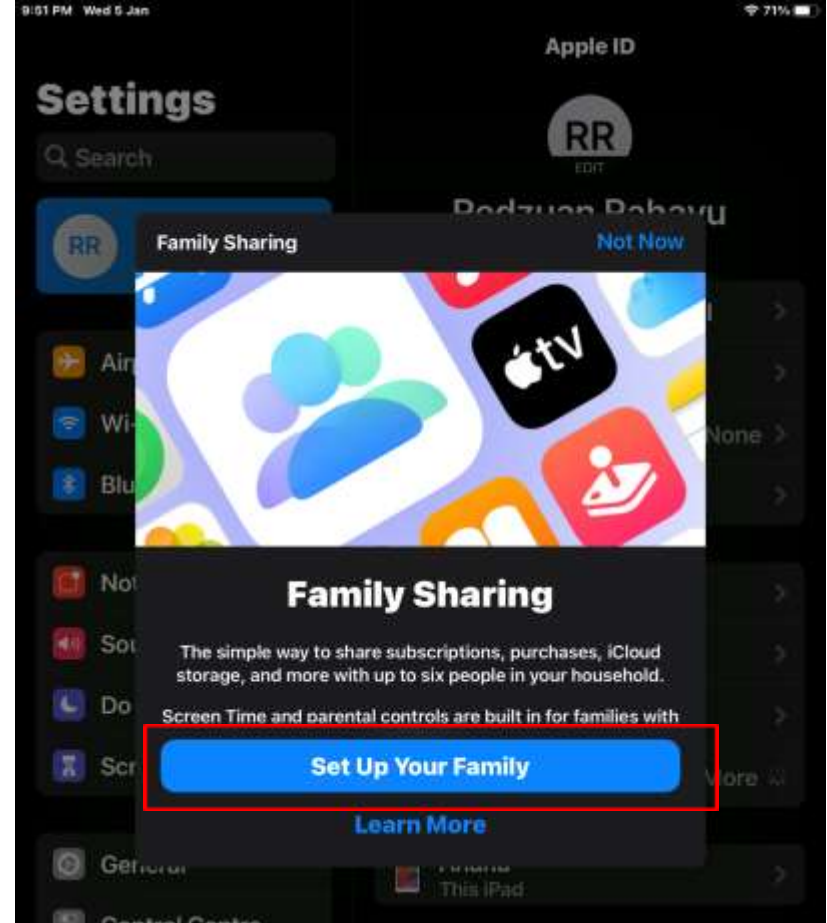

# Family Sharing

To **INVITE** family members to **Family Sharing** from your device

1. Go to Settings > [your name] > Family Sharing.
2. Tap 'Set Up Your Family'
3. Tap 'Create an Account for a Child' (if you have created account for your child / have set up your child's iPad and Apple ID, tap on 'Invite People')

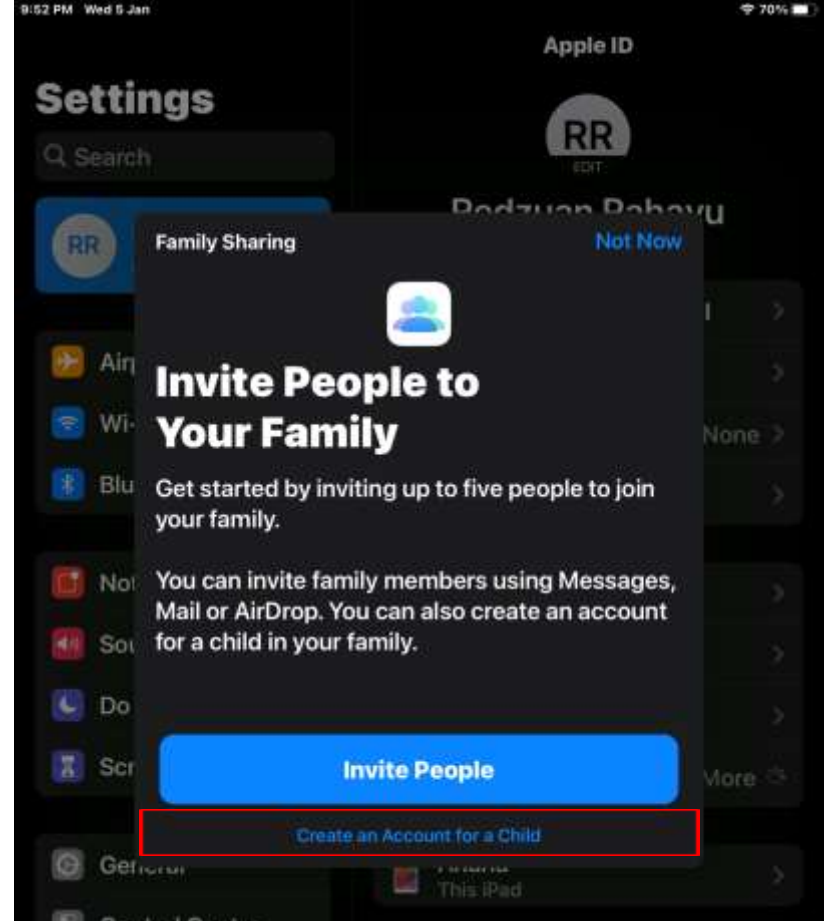



# Family Sharing

To **INVITE** family members to **Family Sharing** from your device

1. Go to Settings > [your name] > Family Sharing.
2. Tap 'Set Up Your Family'
3. Tap 'Create an Account for a Child' (*if you have created account for your child / have set up your child's iPad and Apple ID, tap on 'Invite People'*)
4. Tap Continue

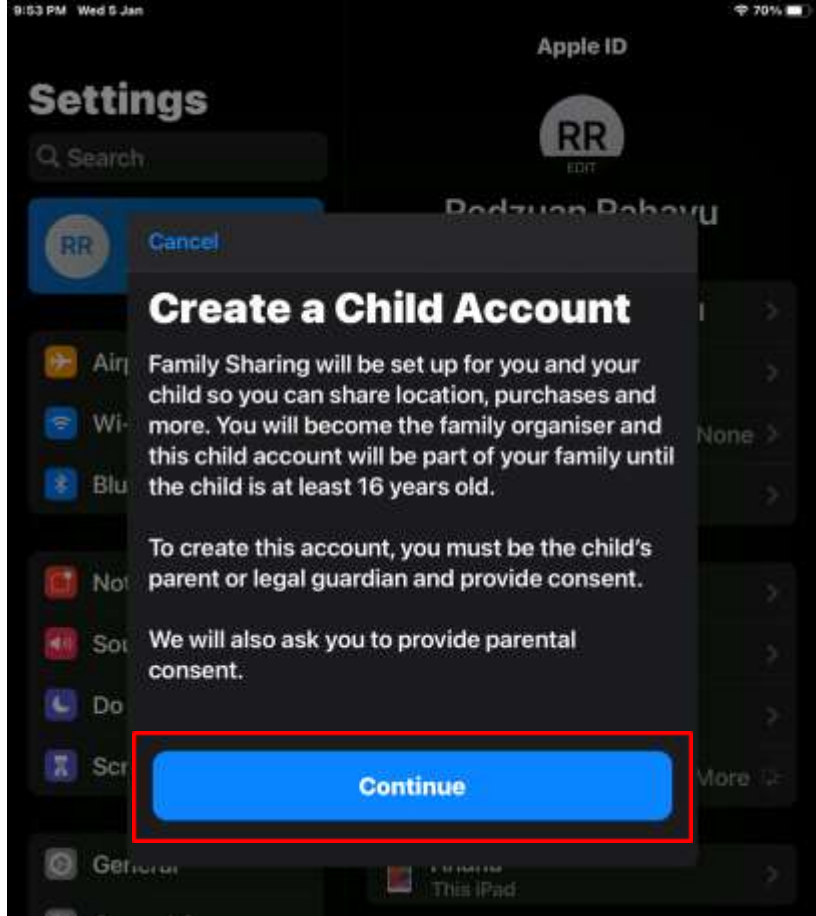

# Family Sharing

To **INVITE** family members to **Family Sharing** from your device

1. Go to Settings > [your name] > Family Sharing.
2. Tap 'Set Up Your Family'
3. Tap 'Create an Account for a Child' (if you have created account for your child / have set up your child's iPad and Apple ID, tap on 'Invite People').
4. Tap 'Continue'. Follow through the steps 1-3

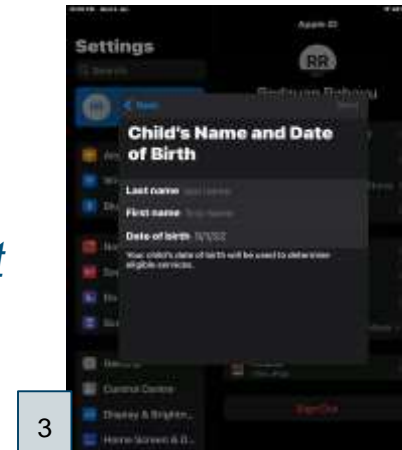
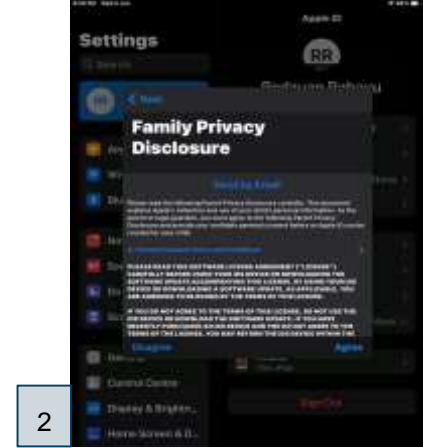
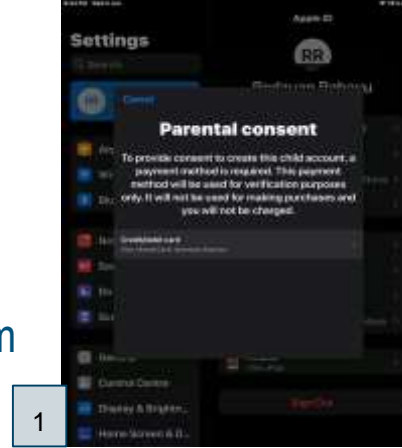

# Family Sharing

To **INVITE** family members to **Family Sharing** from your device

1. Go to Settings > [your name] > Family Sharing.
2. Tap 'Set Up Your Family'
3. Tap 'Create an Account for a Child' (*if you have created account for your child / have set up your child's iPad and Apple ID, tap on 'Invite People'*).
4. Tap 'Continue'. Follow through the steps 1-3
5. Tap on 'Do not have an email address?'

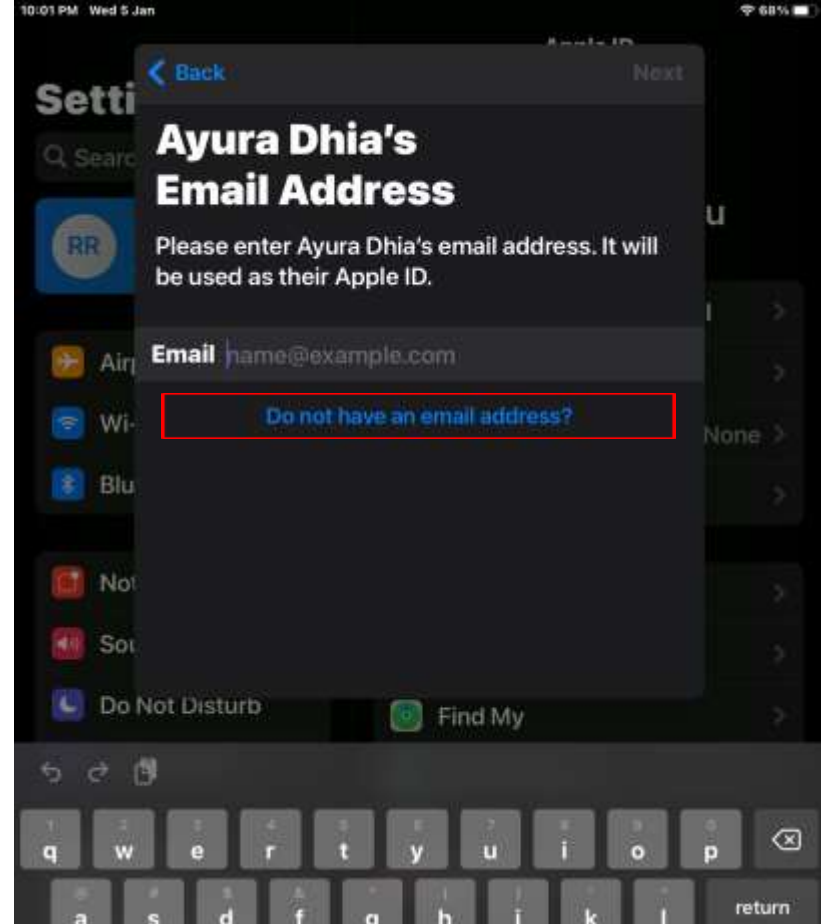

# Family Sharing

To **INVITE** family members to **Family Sharing** from your device

1. Go to Settings > [your name] > Family Sharing.
2. Tap 'Set Up Your Family'
3. Tap 'Create an Account for a Child' (if you have created account for your child / have set up your child's iPad and Apple ID, tap on 'Invite People').
4. Tap 'Continue'. Follow through the steps 1-3
5. Tap 'Do not have an email address?'
6. Tap 'Get an iCloud email address'. Follow through the steps and select 'Agree' when prompted the Terms and Conditions

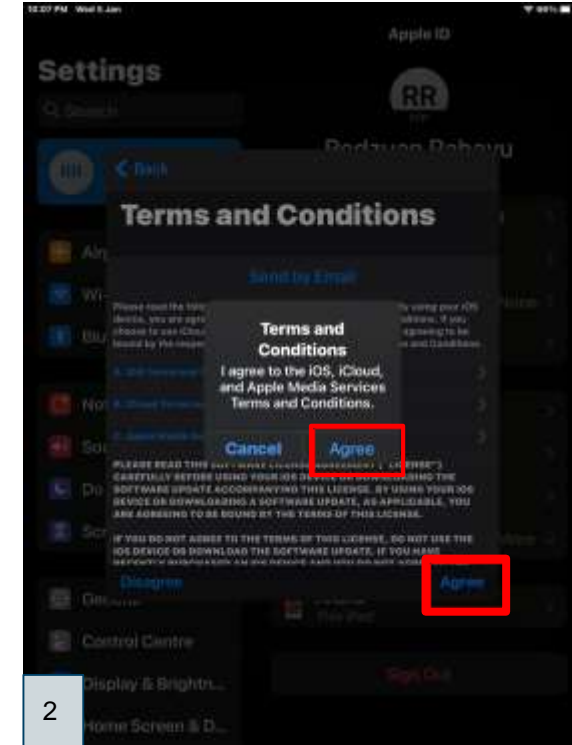
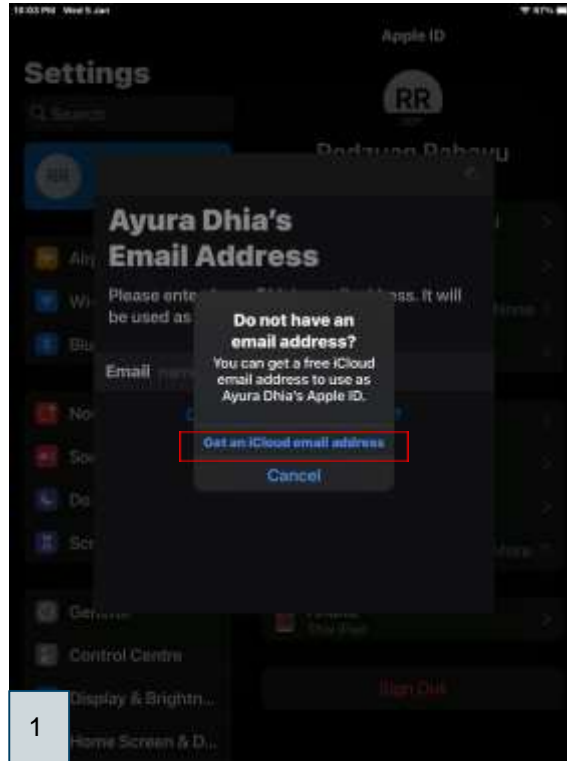

# Family Sharing

To **INVITE** family members to **Family Sharing** from your device

1. Go to Settings > [your name] > Family Sharing.
2. Tap 'Set Up Your Family'
3. Tap 'Create an Account for a Child' (if you have created account for your child / have set up your child's iPad and Apple ID, tap on 'Invite People').
4. Tap 'Continue'. Follow through the steps 1-3
5. Tap 'Do not have an email address?'
6. Tap 'Get an iCloud email address'. Follow through the steps and select 'Agree' when prompted the Terms and Conditions
7. Tap 'Turn On'

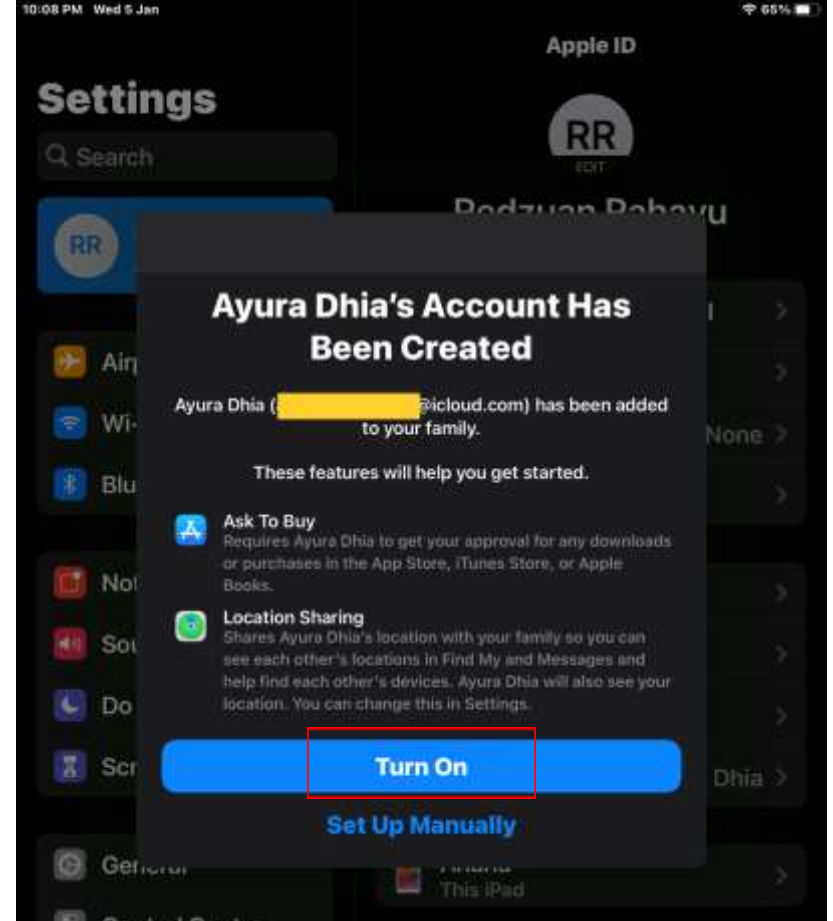

# Family Sharing → Screen Time

## Proceed to set Screen Time from Family Sharing

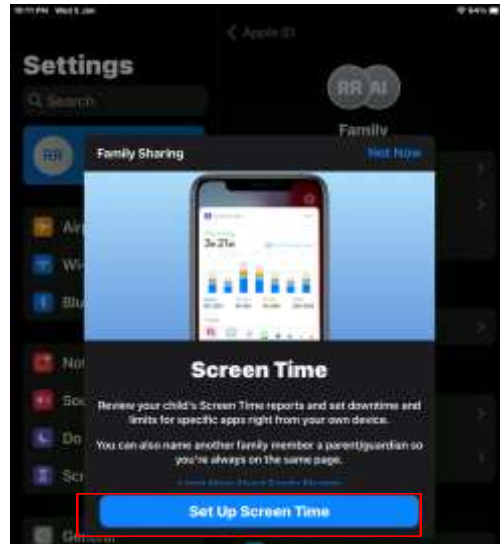

Scroll down. Tap 'Continue'

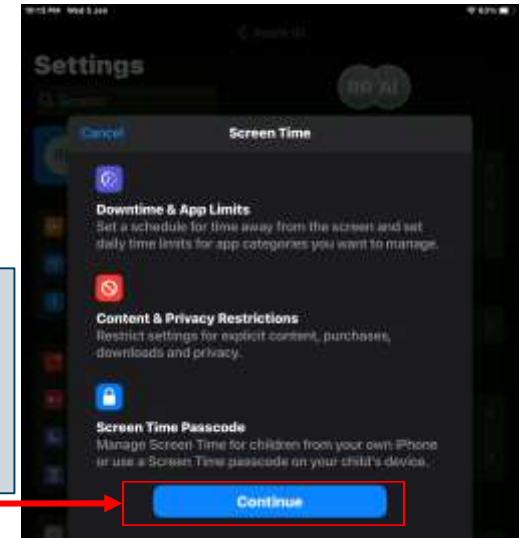

*Wellington Primary School*  
Becoming an excellent institution that grows future-ready leaders

# Family Sharing → Screen Time

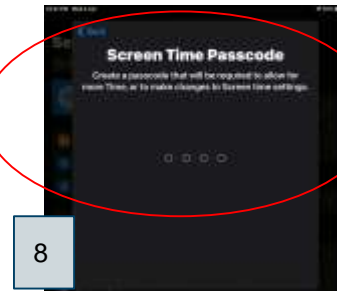
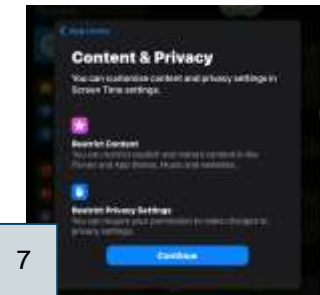
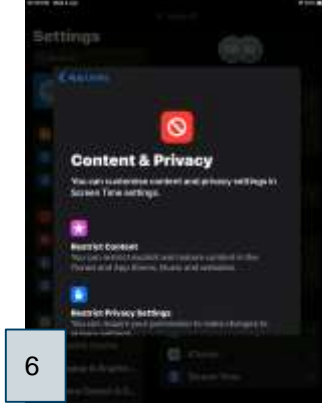
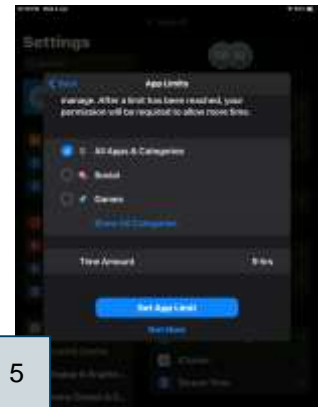
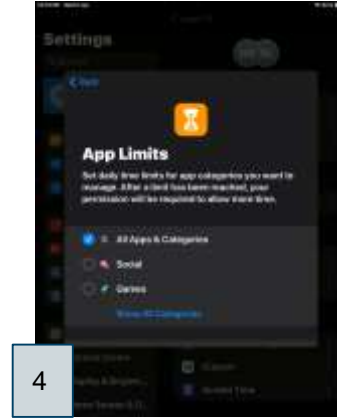
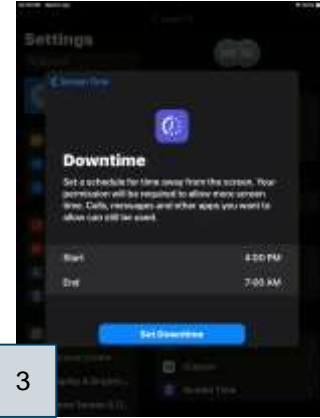
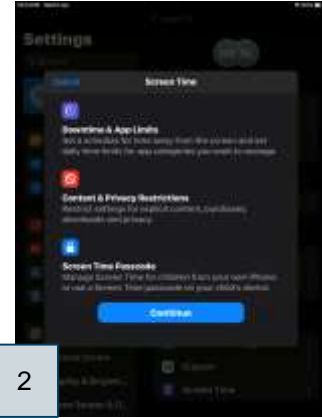
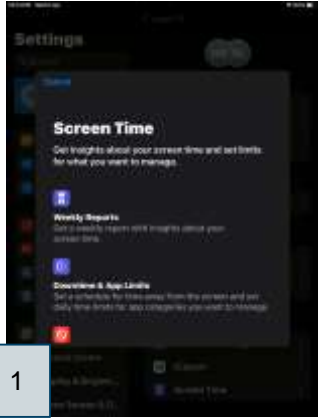

\* Proceed to Slide 48-52 to set more controls

# This is my iPad



- ★ You may start here if you do not wish to add any other user but your iPad is a shared device. This is to prevent other users (your child) from changing your settings



*Wellington Primary School*  
Becoming an excellent institution that grows future-ready leaders



# This is my iPad (parent's iPad)

If this is your device or a shared iPad, to prevent another family member from changing your settings, go to **Settings**.



*Wellington Primary School*  
Becoming an excellent institution that grows future-ready leaders

# This is my iPad (parent's iPad)

If this is your device or a shared iPad, to prevent another family member from changing your settings, go to **Settings**, tap

## 1. Screen Time

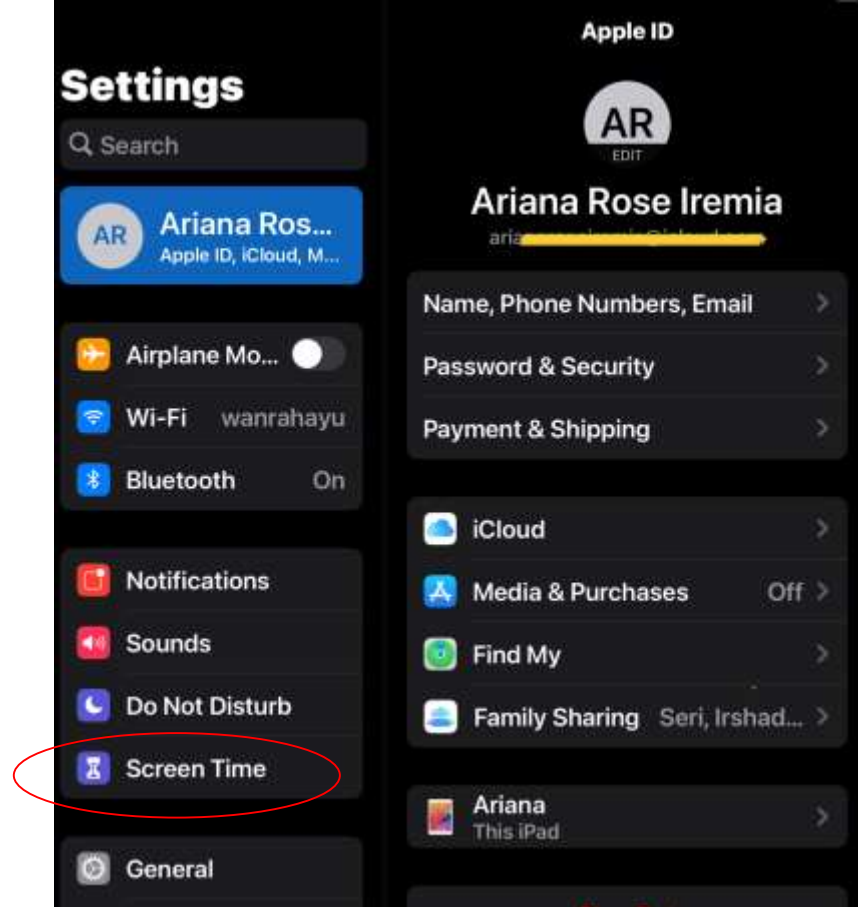

# This is my iPad (parent's iPad)

If this is your device or a shared iPad, to prevent another family member from changing your settings, go to **Settings**, tap

1. Screentime
2. Continue

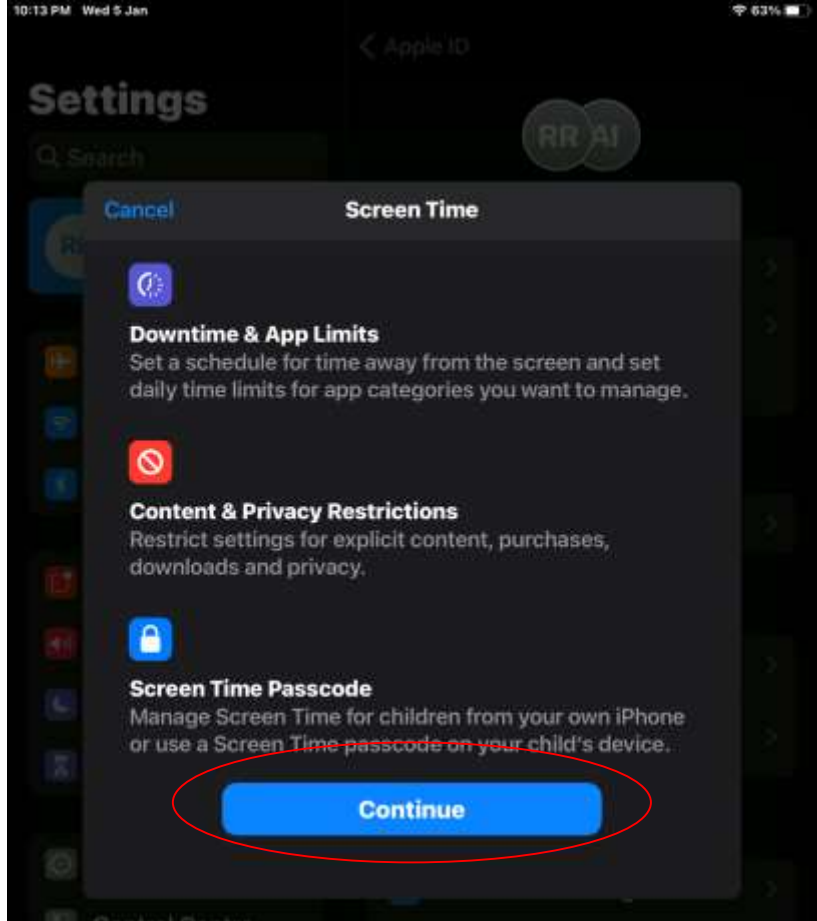

*Wellington Primary School*  
Becoming an excellent institution that grows future-ready leaders

# This is my iPad (parent's iPad)

If this is your device or a shared iPad, to prevent another family member from changing your settings, go to **Settings**, tap

1. Screentime
2. Continue
3. This is my iPad

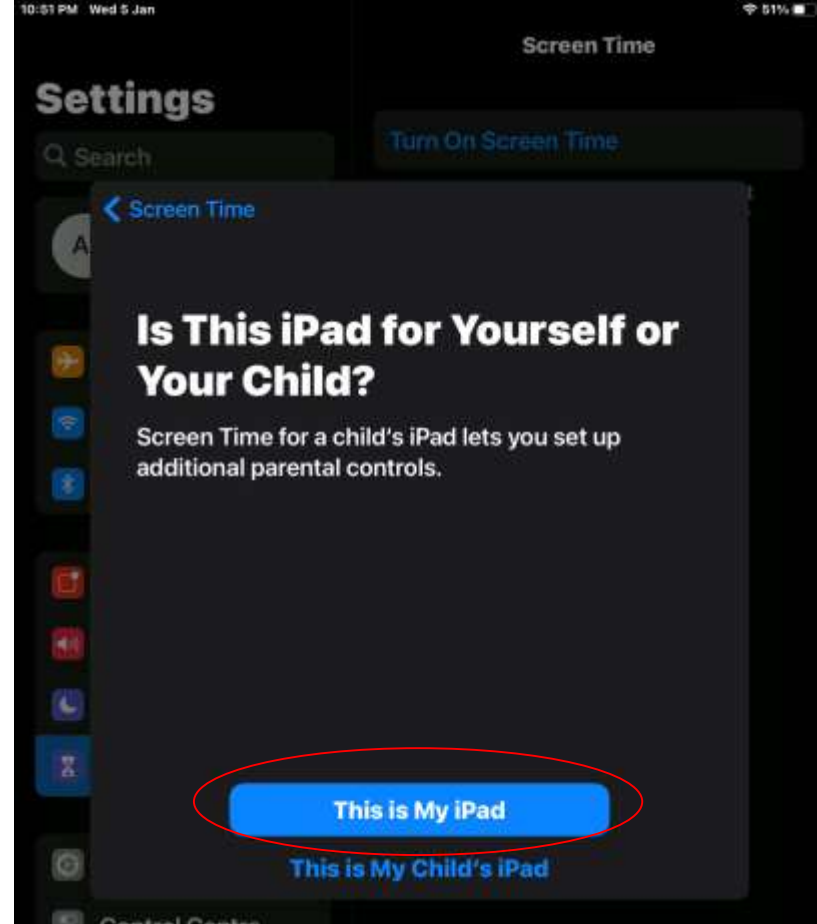

# This is my iPad (parent's iPad)

If this is your device or a shared iPad, to prevent another family member from changing your settings, go to **Settings**, tap

1. Screen Time
2. Continue
3. This is my iPad
4. Use Screen Time
5. Create Passcode

Go through steps 1 - 7 before you can enter the Passcode.

**\*Remember to create a 4-digit passcode, different from your iPad's passcode**

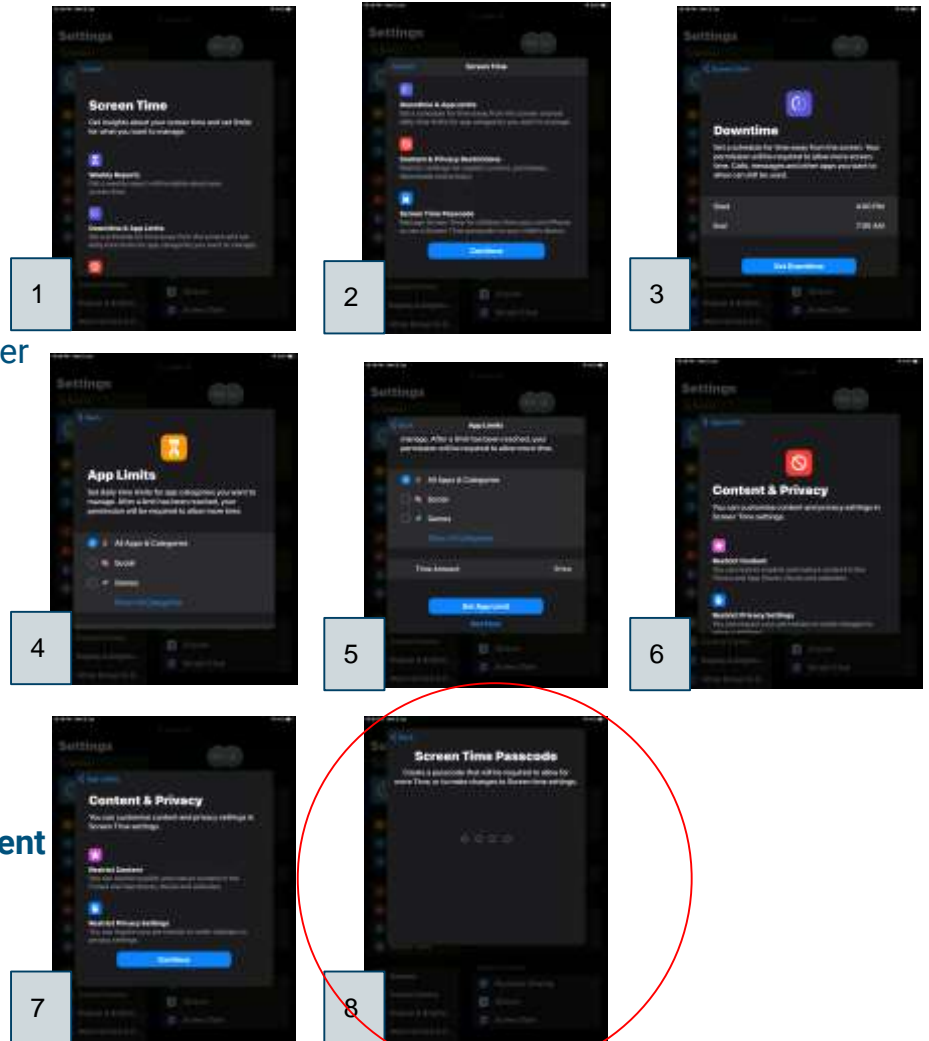



# This is my child's iPad

- ★ You may start here if you do not wish to change anything to the iPad used by your child and you want to set screen time.



*Wellington Primary School*  
Becoming an excellent institution that grows future-ready leaders

# This is my child's iPad

Please create your own Apple ID (parent/guardian) before proceeding. (Refer to slide 11 to create your Apple ID if you are not an iOS user.)

If this is your child's device, go to **Settings**, tap

1. Screentime
2. Continue
3. This is my child's iPad
4. 'Not Now' for Downtime & App Limits
5. 'Continue' for Content & Privacy
6. Create Screen Time Passcode. This is different from the passcode your child use to log on their iPad.
7. Enter your (parent's) Apple ID. This will help you in case you have forgotten the 4-digit passcode for Screen Time



# This is my child's iPad

Please create your own Apple ID  
(parent/guardian) before proceeding.  
(Refer to slide 11 to create your Apple  
ID if you are not an iOS user.)

If this is your child's device, go to  
**Settings.**



*Wellington Primary School*  
*Becoming an excellent institution that grows future-ready leaders*



# This is my child's iPad

Please create your own Apple ID (parent/guardian) before proceeding. (Refer to slide 11 to create your Apple ID if you are not an iOS user.)

If this is your child's device, go to Settings, tap

1. Screen Time

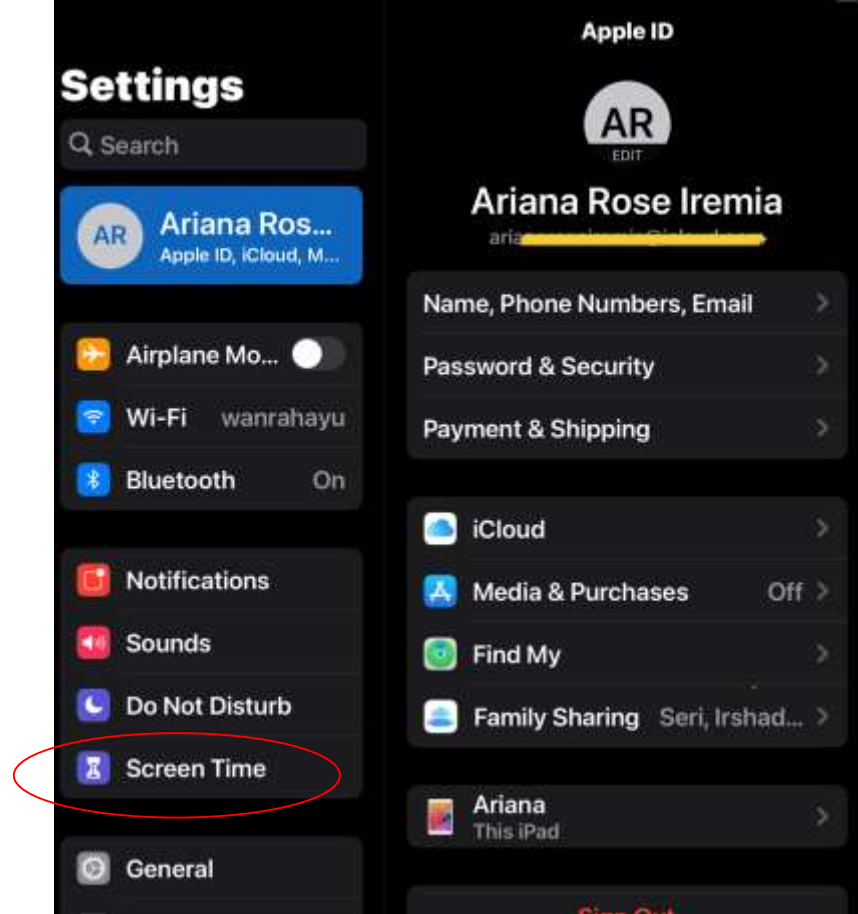

# This is my child's iPad

Please create your own Apple ID (parent/guardian) before proceeding. (Refer to slide 11 to create your Apple ID if you are not an iOS user.)

If this is your child's device, go to Settings, tap

1. Screentime
2. Continue

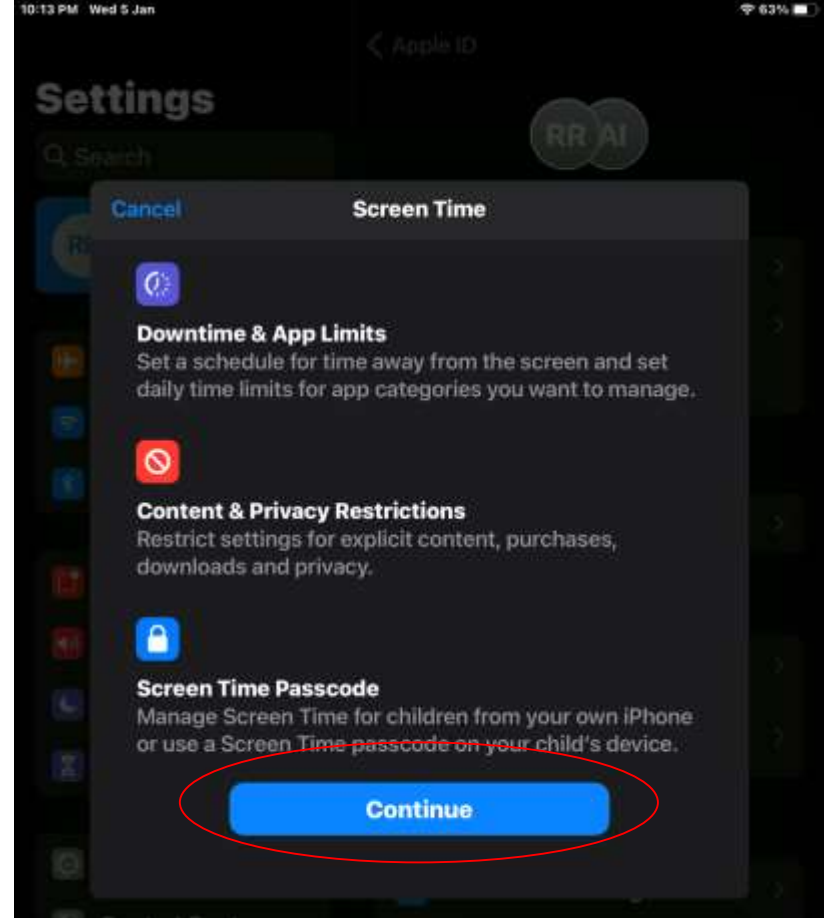

# This is my child's iPad

Please create your own Apple ID (parent/guardian) before proceeding. (Refer to slide 11 to create your Apple ID if you are not an iOS user.)

If this is your child's device, go to Settings, tap

1. Screentime
2. Continue
3. This is my child's iPad

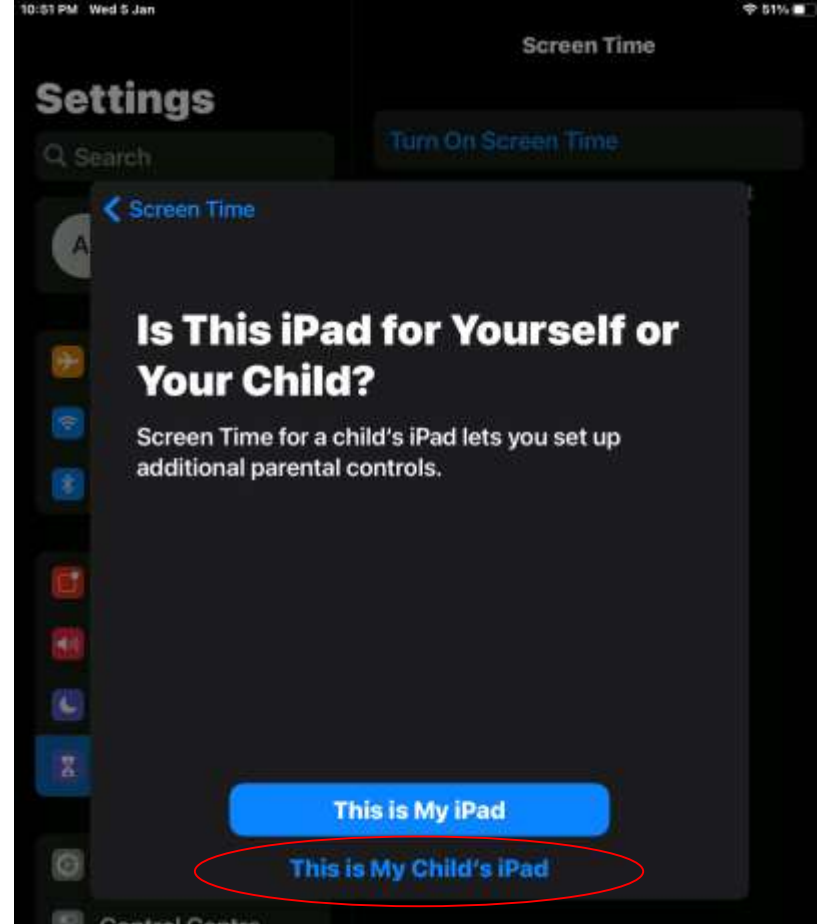

# This is my child's iPad

Please create your own Apple ID (parent/guardian) before proceeding. (Refer to slide 11 to create your Apple ID if you are not an iOS user.)

If this is your child's device, go to Settings, tap

1. Screen Time
2. Continue
3. This is my child's iPad
4. 'Not Now' for Downtime & App Limits

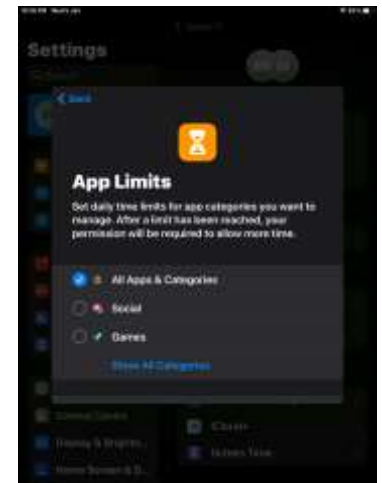
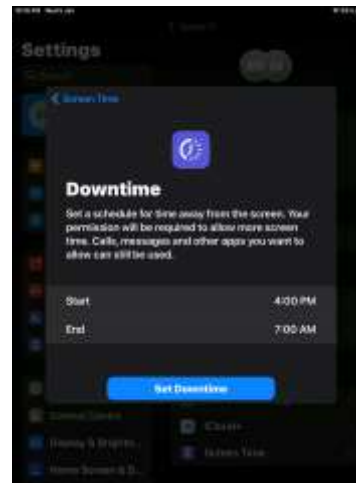

Scroll down on both **Downtime** and **App Limits** to select 'Not Now'.

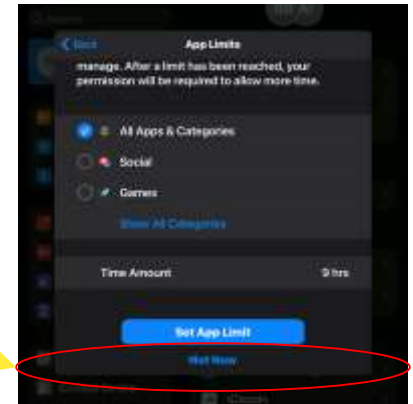

*Wellington Primary School*  
Becoming an excellent institution that grows future-ready leaders

# This is my child's iPad

Please create your own Apple ID (parent/guardian) before proceeding. (Refer to slide 11 to create your Apple ID if you are not an iOS user.)

If this is your child's device, go to Settings, tap

1. Screentime
2. Continue
3. This is my child's iPad
4. 'Not Now' for Downtime & App Limits
5. 'Continue' for Content & Privacy

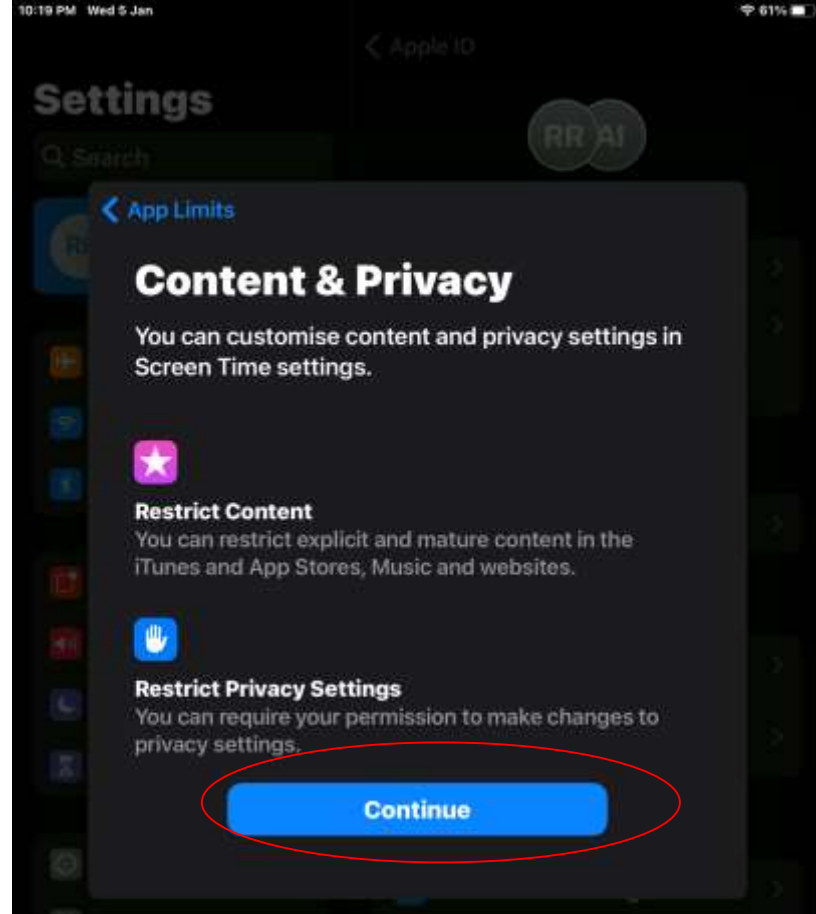

# This is my child's iPad

Please create your own Apple ID (parent/guardian) before proceeding. (Refer to slide 11 to create your Apple ID if you are not an iOS user.)

If this is your child's device, go to Settings, tap

1. Screentime
2. Continue
3. This is my child's iPad
4. 'Not Now' for Downtime & App Limits
5. 'Continue' for Content & Privacy
6. Create Screen Time Passcode.

**\*Remember to create a 4-digit passcode, different from your iPad's passcode**

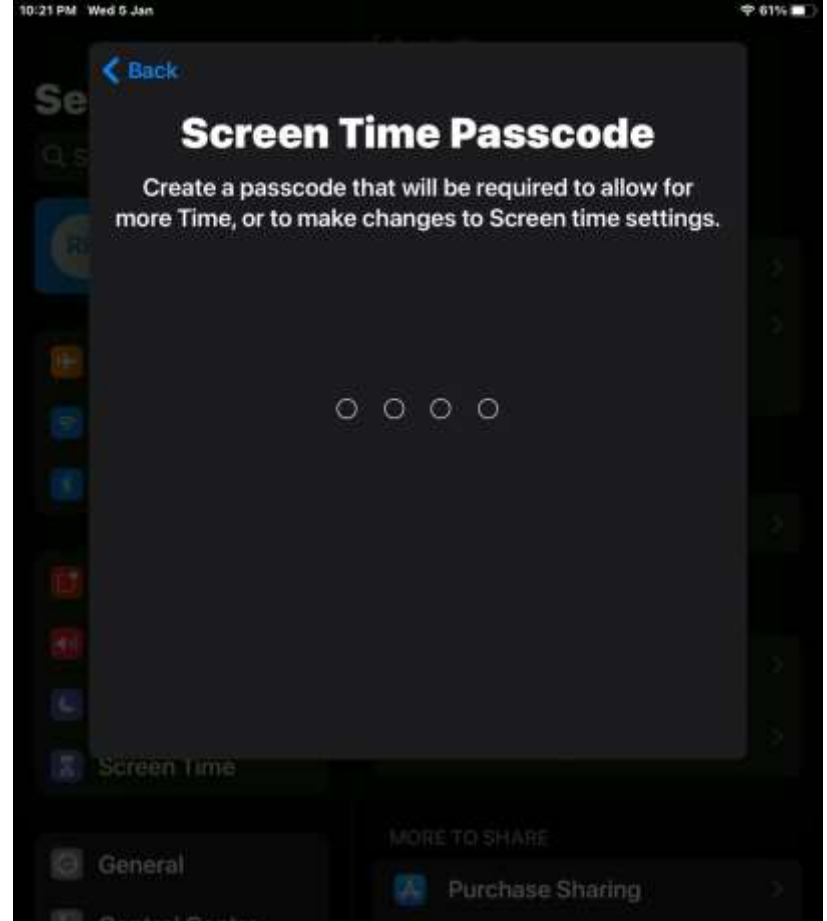

*Wellington Primary School*  
Becoming an excellent institution that grows future-ready leaders

# This is my child's iPad

Please create your own Apple ID (parent/guardian) before proceeding. (Refer to slide 11 to create your Apple ID if you are not an iOS user.)

If this is your child's device, go to Settings, tap

1. Screen Time
2. Continue
3. This is my child's iPad
4. 'Not Now' for Downtime & App Limits
5. 'Continue' for Content & Privacy
6. Create Screen Time Passcode. This is different from the passcode your child use to log on their iPad.
7. Enter your (parent's) Apple ID. This will help you in case you have forgotten the 4-digit passcode for Screen Time

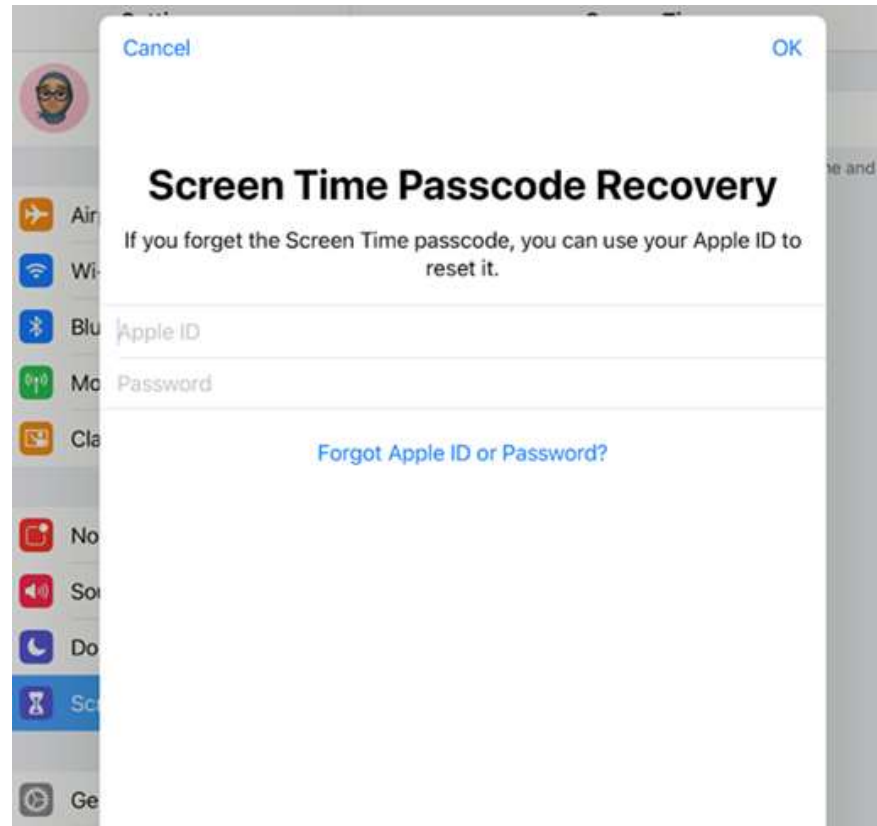

# This is my child's iPad

8. On Screen Time, tap Downtime, and turn the tab on.

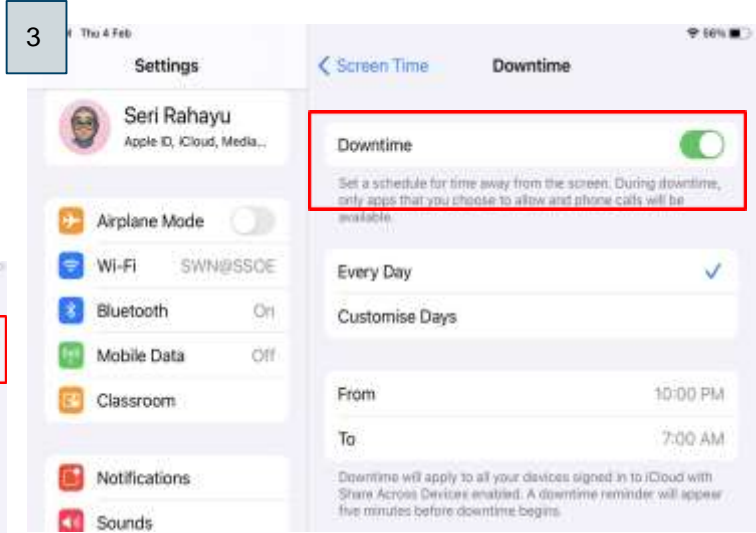



# This is my child's iPad

9. On Screen Time, tap App Limits, and then Add Limit. You can choose to set limits to individual categories. (Eg., Games - 1 hr. To add another limit for another category, simply tap on Add Limit again.)

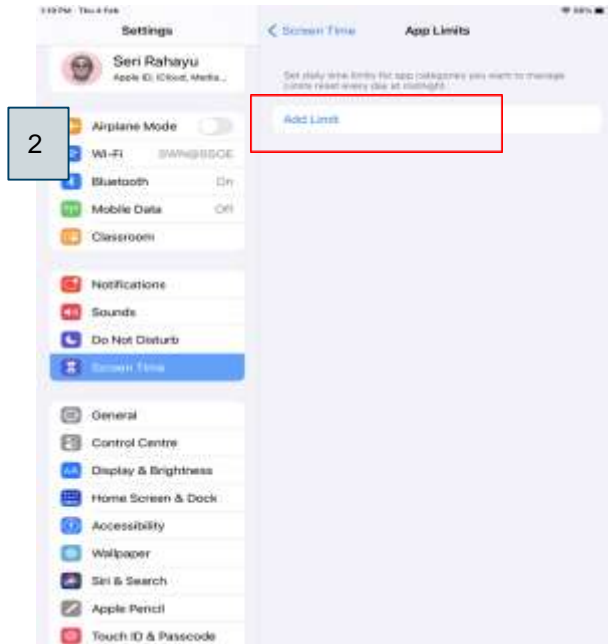
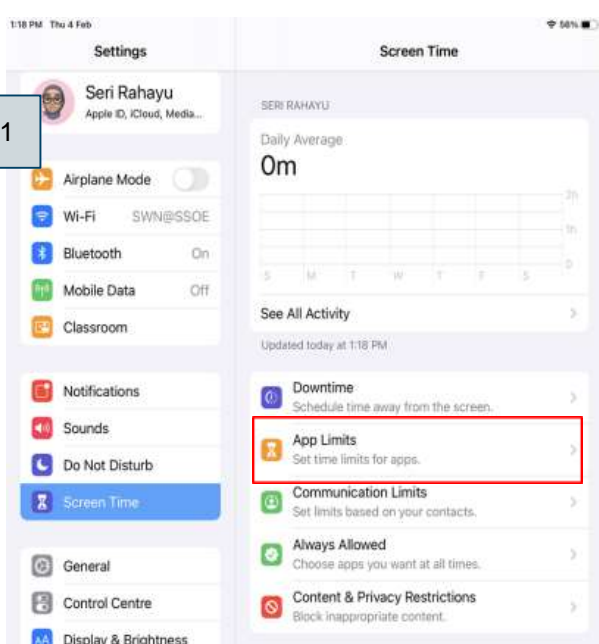

# This is my child's iPad

10. On Screen Time, tap Content & Privacy Restrictions.

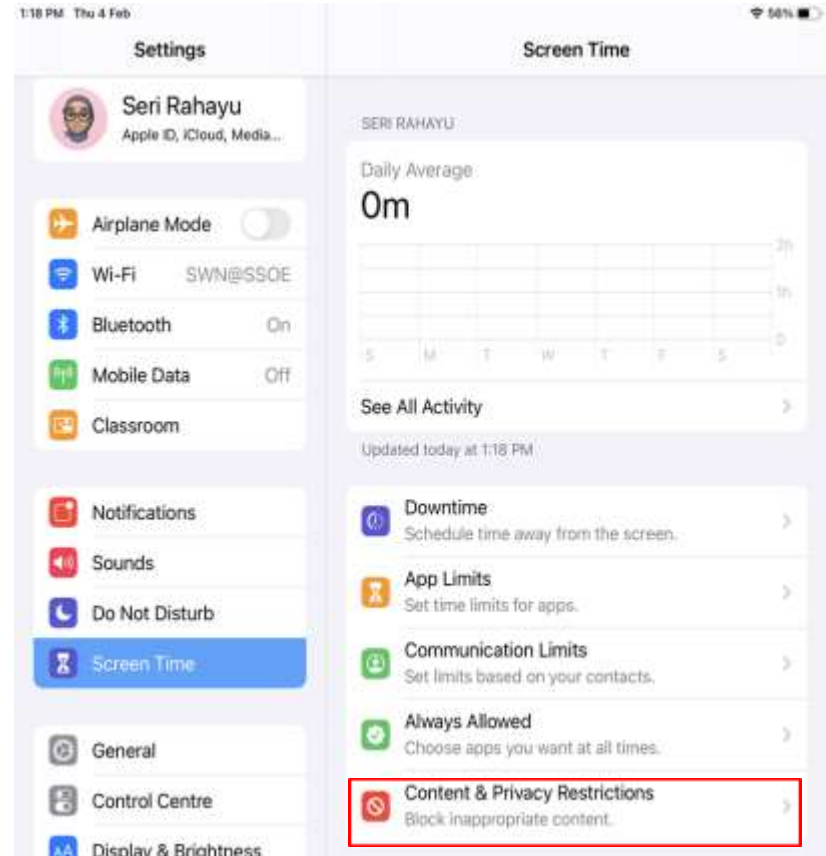

*Wellington Primary School*  
Becoming an excellent institution that grows future-ready leaders

# This is my child's iPad

Your child will need your permission to download apps. Ensure you tap on Always Require Password.

Click on individual items and change to suit your child's needs.

Tap and change to 'Don't allow'.

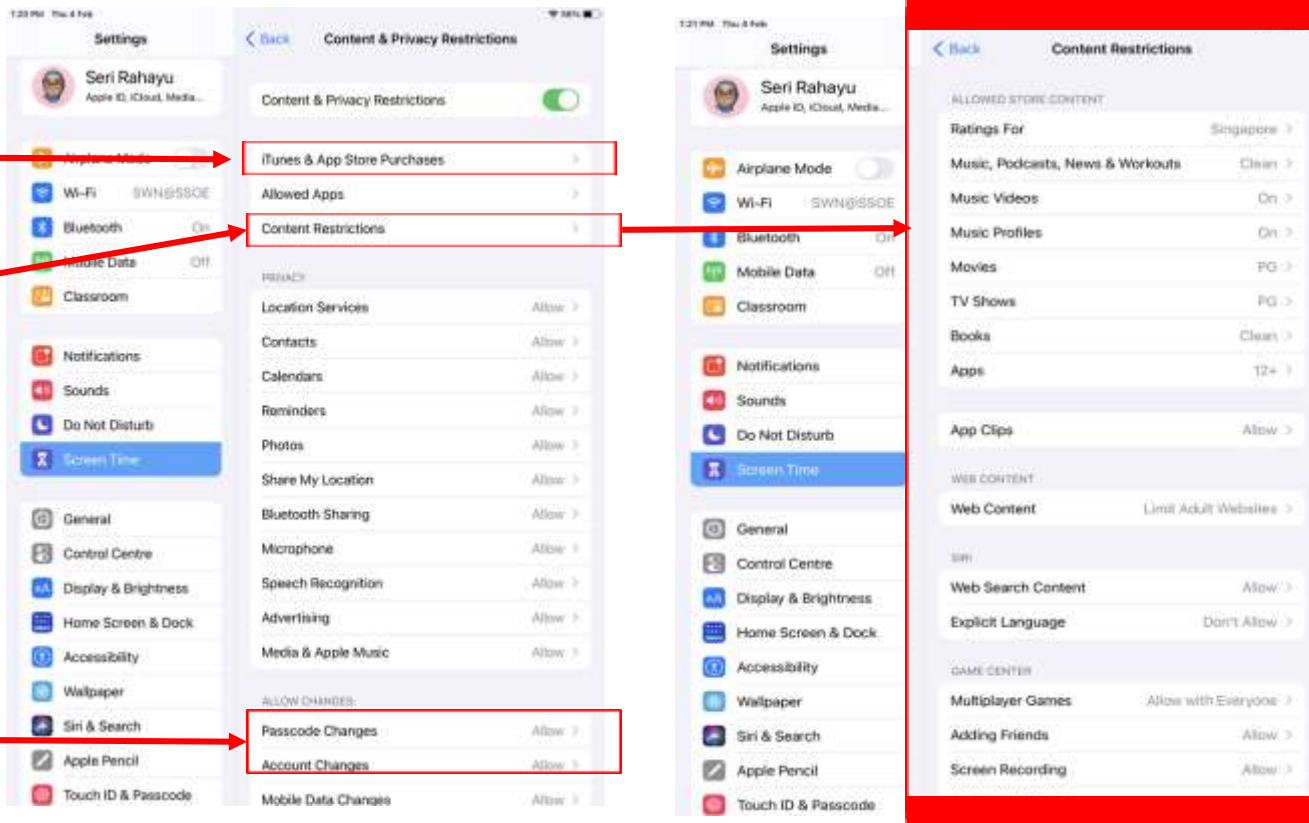

# Setting controls on Youtube



*Wellington Primary School*  
*Becoming an excellent institution that grows future-ready leaders*

# Youtube Parental Control

Youtube Parental Control is a must if you are letting your kids use the Youtube app or Youtube website.

Alternatively, you can use Youtube Kids



*Wellington Primary School*  
*Becoming an excellent institution that grows future-ready leaders*

# Youtube Parental Control



Youtube Parental Control is a must if you are letting your kids use the Youtube app or Youtube website.

Step 1:

Tap on **YouTube icon** on iPad

Step 2:

Click on account icon, then scroll down to click on 'Settings'

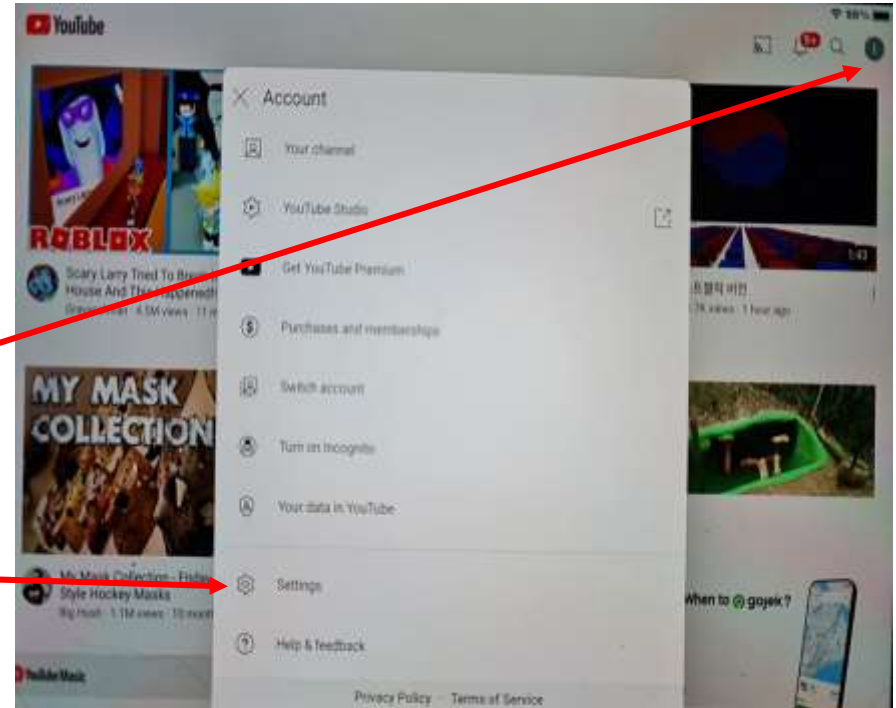

*Wellington Primary School*  
Becoming an excellent institution that grows future-ready leaders

# Youtube Parental Control

Youtube Parental Control is a must if you are letting your kids use the Youtube app or Youtube website.

Step 1:

Tap on **YouTube icon** on iPad

Step 2:

Click on account icon, then scroll down to click on 'Settings'

Step 3:

Tap on 'Restricted Mode'

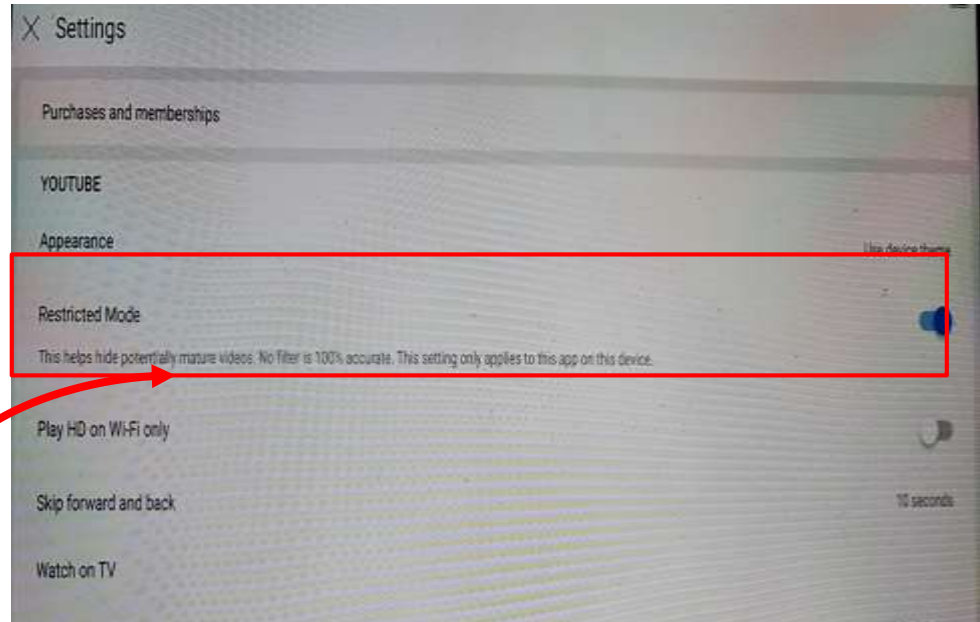

# Setting controls on Google





# Google Parental Control

Step 1:  
Sign in to Google  
account

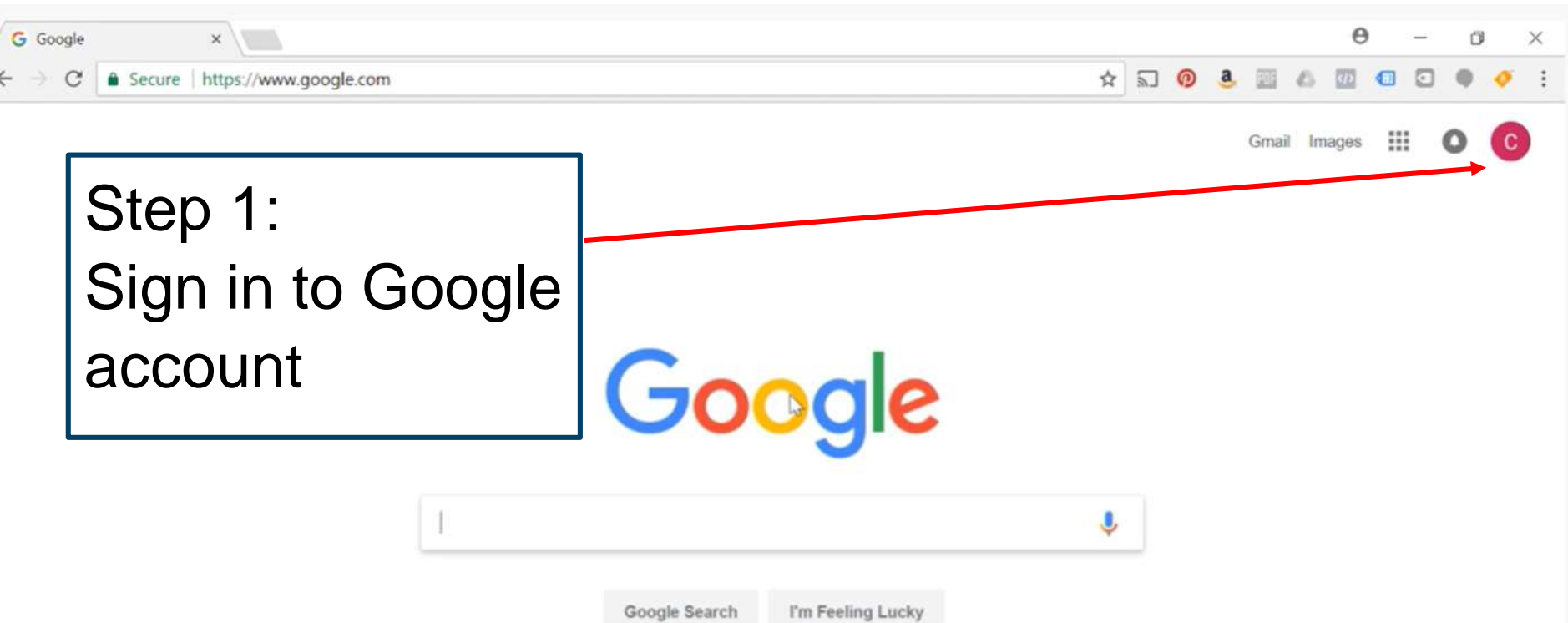

*Wellington Primary School*  
Becoming an excellent institution that grows future-ready leaders

# Google Parental Control

Step 2:  
Type  
google.com/preferences

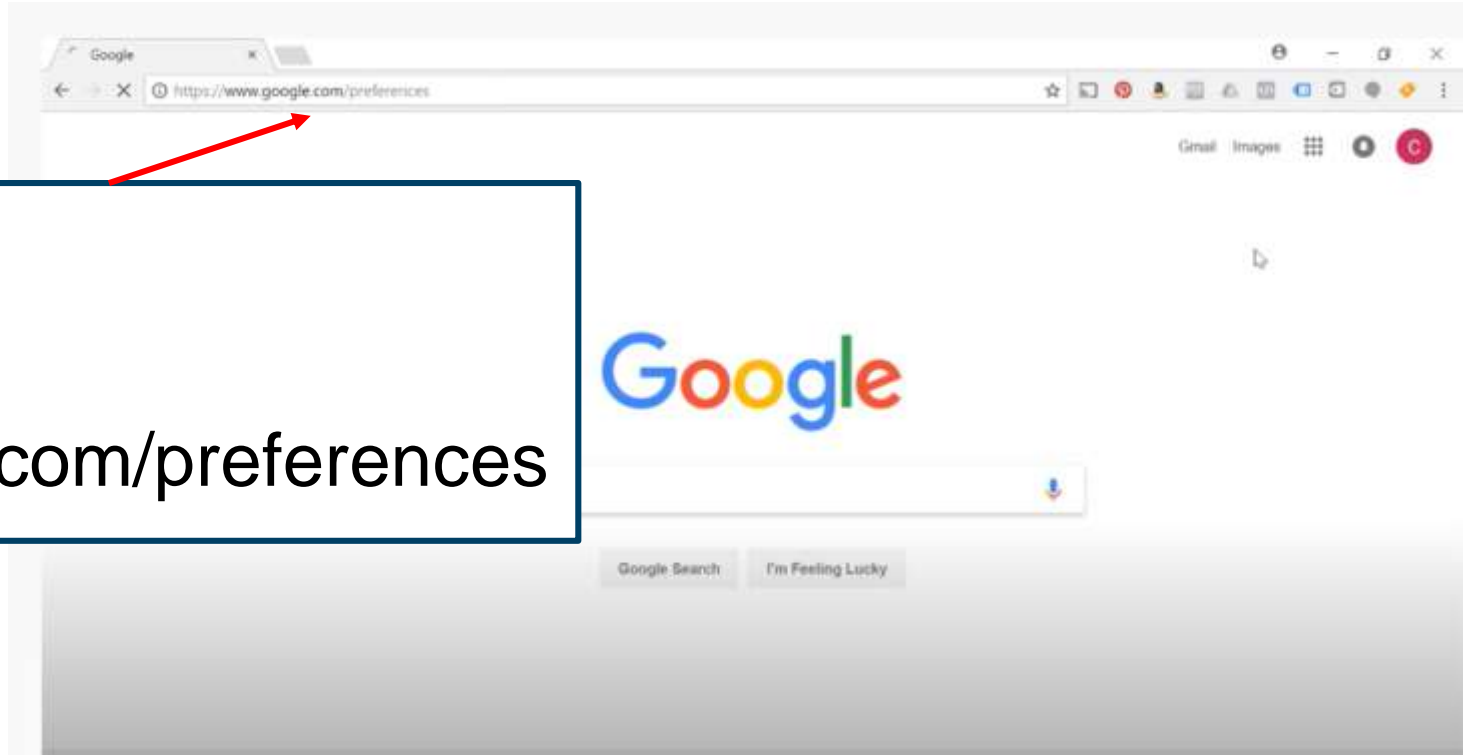

# Google Parental Control

Step 3:  
Click on  
SafeSearch,  
then Lock  
SafeSearch

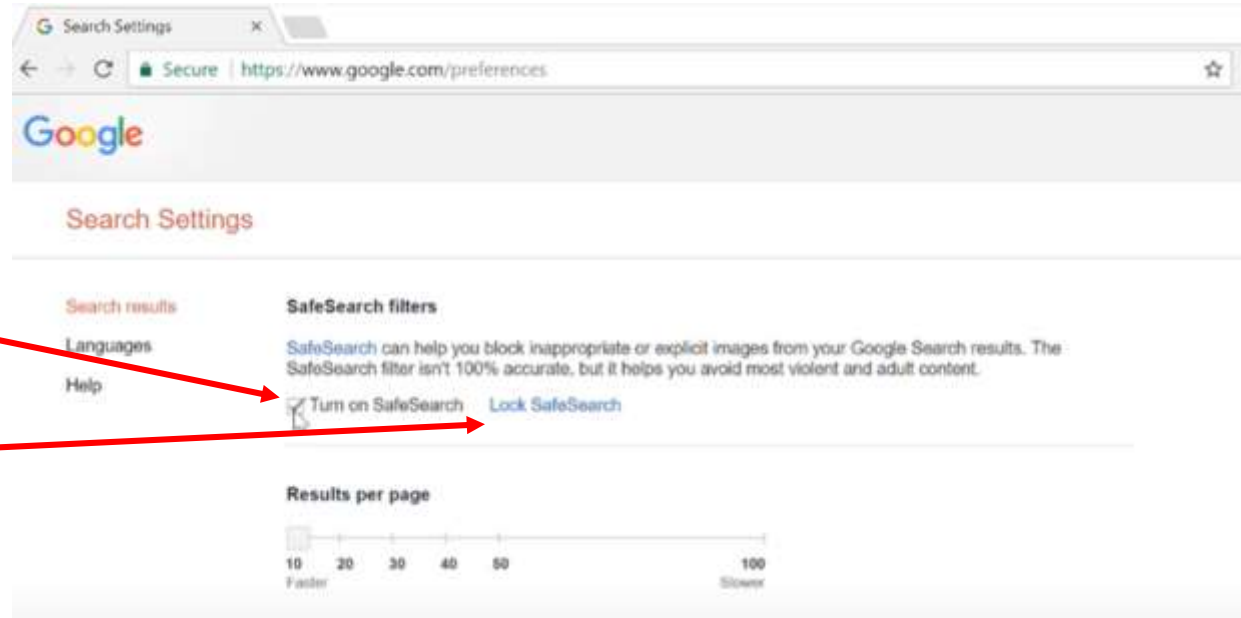

# Google Parental Control

Step 4:  
Click on Lock  
SafeSearch

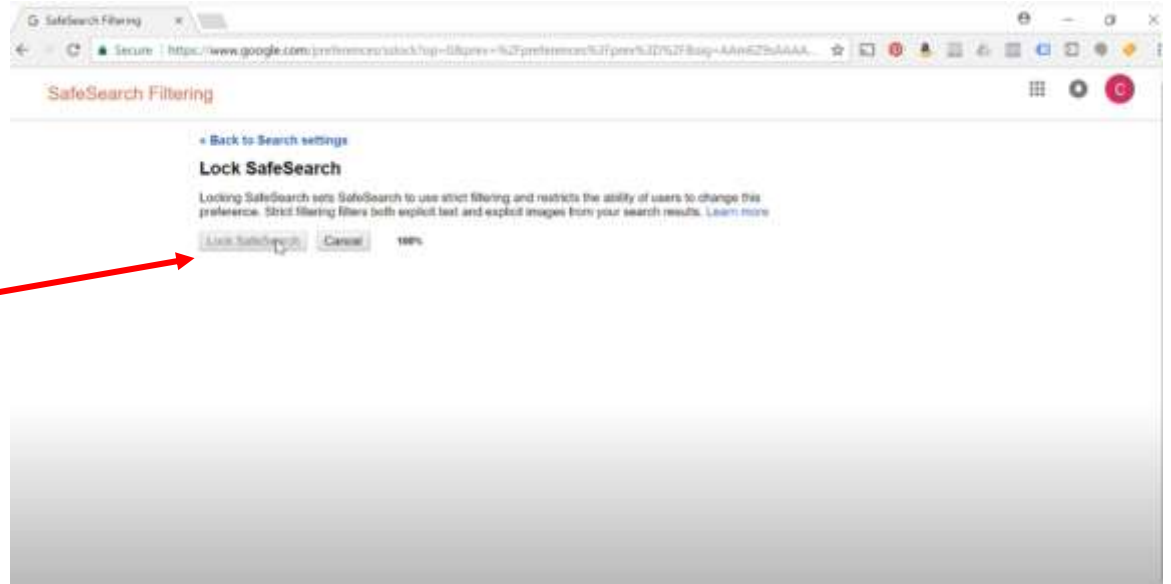

# Google Parental Control

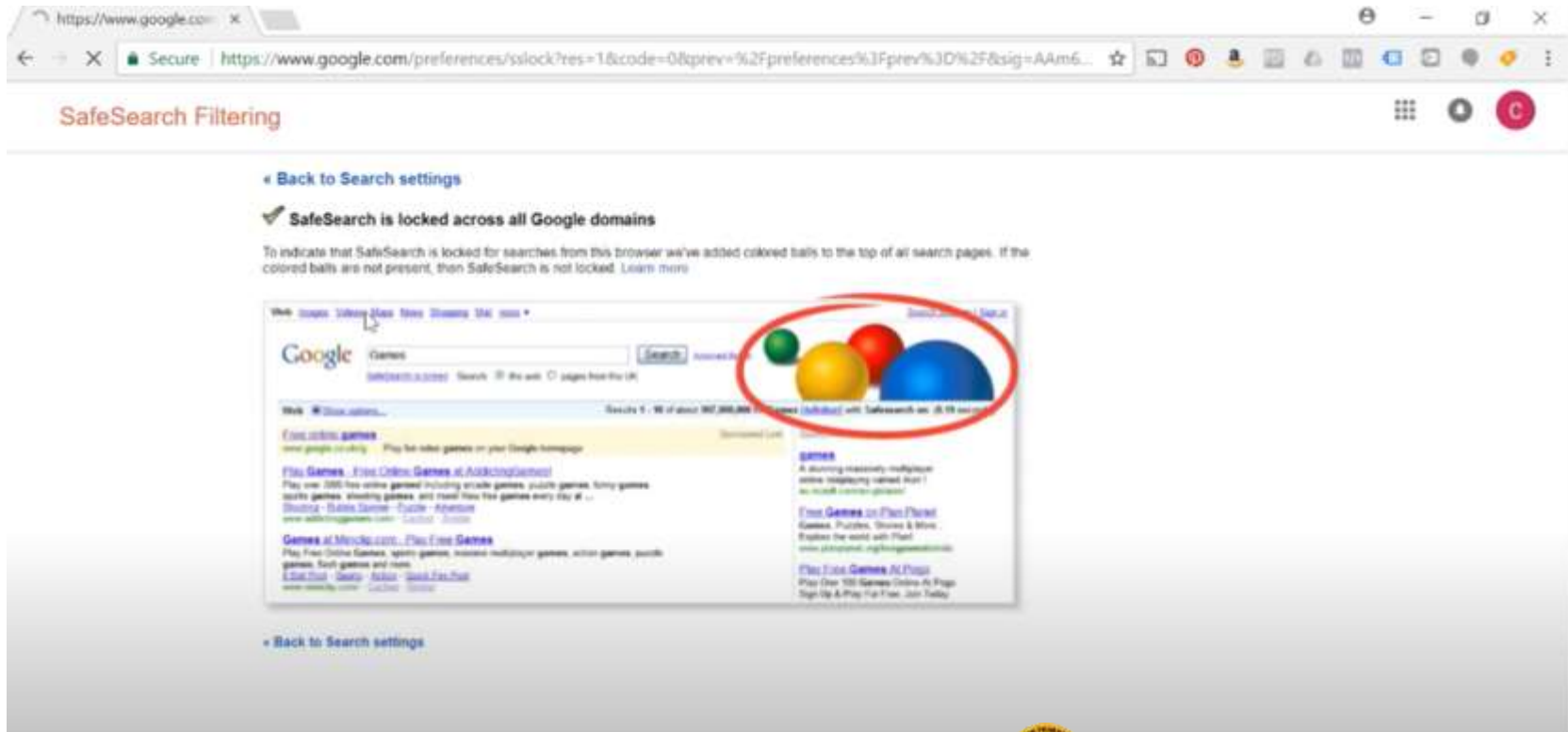

The screenshot shows a web browser window with the URL <https://www.google.com/preferences/sslock?res=1&code=0&prev=%2Fpreferences%3Fprev%3D%2F&sig=AAm6...>. The page title is "SafeSearch Filtering".

Navigation: [Back to Search settings](#)

Status: **SafeSearch is locked across all Google domains**

Explanation: To indicate that SafeSearch is locked for searches from this browser we've added colored balls to the top of all search pages. If the colored balls are not present, then SafeSearch is not locked. [Learn more](#)

Visual Evidence: A screenshot of a Google search results page for "Games" is shown. A red circle highlights the four colored balls (green, yellow, red, blue) at the top right of the search results page, which are present because SafeSearch is locked.

Navigation: [Back to Search settings](#)



Thank you



*Wellington Primary School*  
*Becoming an excellent institution that grows future-ready leaders*